

Data sheet**OpDAT splice tray for KR50/55**

Page 1/4

P/N
150802-E

EAN 4250184109181

2023/03/30

Version: M

Illustrations

Dimensional drawing

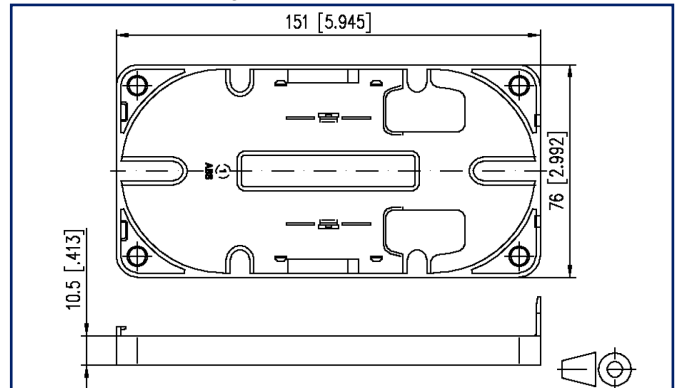

See enlarged drawings at the end of document

Product specification

- to receive up to 4 fusion splices
- engages in cable reservoir



P | Cabling

Data sheet OpDAT splice tray for KR50/55

Page 2/4

P/N

150802-E

EAN 4250184109181

2023/03/30

Version: M

Technical Data

General Data

Mechanical measurement according to MICE	M1
Ingress measurement according to MICE	I1
Climatic measurement according to MICE	C1
Electromagnetic measurement according to MICE	E3
Design	splice tray
Mounting style	Accessories
Color	pearl white RAL 1013
Dimensions	
Dimension (L x W x H)	10.5 mm x 151 mm x 76 mm
Dimension (L x W x H)	0.413 in. x 5.945 in. x 2.992 in.

Materials and material properties

Material	ABS
Halogen free	yes
RoHS	compliant

Classifications

ETIM 5.0	EC000441
ETIM 6.0	EC000441
ETIM 7.0	EC002066
ETIM 8.0	EC002066
ETIM 9.0	EC002066

Packing details

Type of packaging	1 pc(s) / plastic bag
Packaging unit - Weight (gram)	52 g
Packaging unit - Weight (pound)	0.11 lb
Packaging dimension	160 mm x 100 mm x 380 mm
Packaging dimension	6.299 in. x 3.937 in. x 14.961 in.

P | Cabling

Data sheet

OpDAT splice tray for KR50/55

Page 3/4

P/N
150802-E

EAN 4250184109181

2023/03/30

Version: M

Accessories from

P/N	Designation
150800501-E	OpDAT KR 50 cable reservoir 50 mm
150800551-E	OpDAT KR 55 cable reservoir 55 mm



P | Cabling

Data sheet

OpDAT splice tray for KR50/55

Page 4/4

P/N
150802-E

EAN 4250184109181

2023/03/30

Version: M

Illustrations

Dimensional drawing

