

# Data sheet

## RP034xxHBLO Type 113

### Illustrations



Dimensional drawing

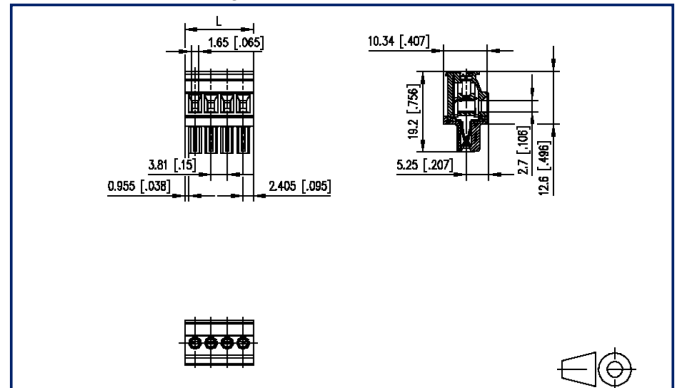

See enlarged drawings at the end of document

### Product specification

- screw type terminal block, pluggable
- centerline 3.81 mm, direction of connection 90°
- lift system
- color black
- wire entry codeable side perpendicular to plug direction



## Data sheet RP034xxHBLO Type 113

Page 2/5

P/N  
311131xx

xx=number of poles

2023/06/26

Version: U

### Technical Data

#### General Data

Tightening torque SEV	0.25 Nm		
Tightening torque UL	2.2 lb-in		
min. number of poles	2		
max. number of poles	21		
Insulating material class	CTI 600		
clearance/creepage dist.	2.9 mm		
Protection category	IP20		
Min. insul. strip length	7 mm		
Rated current	9 A		
Overvoltage category	III	III	II
Pollution degree	3	2	2
Rated voltage	40 V	250 V	250 V
Rated test voltage	1.5 kV	1.5 kV	1.5 kV

#### Terminal data

rat.wiring solid AWGmax	0.08 mm <sup>2</sup> - 2 mm <sup>2</sup> / AWG 28 - AWG 14		
rat.wiring strand.AWGmax	0.08 mm <sup>2</sup> - 1.5 mm <sup>2</sup> / AWG 28 - AWG 16		

#### Approvals

extended wiring UL	Wire range extended to 14 AWG solid only.		
--------------------	---	--	--



V / A / AWG

300 / 11 / 28 - 16

approval UL - File No.	E121004		
------------------------	---------	--	--



1.5 mm<sup>2</sup>

160 V / 2.5 kV / 9 A

#### Material

insulating material	PA66		
flammability class	V0		
contact material	CuSn		
Contact surface	Sn		
terminal body thread	M2		
terminal body material	CuZnPb		
terminal body surface	Ni		
screw thread	M2		



**Data sheet**  
**RP034xxHBLO Type 113**

Page 3/5

P/N  
311131xx

xx=number of poles

2023/06/26

Version: U

**Technical Data**

screw material	8,8
screw surface	Zn Cr(VI)-frei/free
Glow-Wire Flammability GWFI	960 °C acc. to IEC 60695-2-12
Glow-Wire Flammability GWIT	775 °C acc. to IEC 60695-2-13

**Climatic Data**

upper limit temperature	105 °C
lower limit temperature	-40 °C

**general**

Tolerance	ISO 2768 -mH
-----------	--------------

# U | Contact

Data sheet  
RP034xxHBLO Type 113

Page 4/5

P/N  
311131xx

xx=number of poles

2023/06/26

Version: U

## Counterpart

P/N	Designation
311901	PR044xxHBBN Type 190
311911	PR044xxVBBN Type 191
313821	PT094xxHBBN Type 382
313831	PT094xxVBBN Type 383



# U | Contact

## Data sheet RP034xxHBLO Type 113

Page 5/5

P/N  
311131xx

xx=number of poles

2023/06/26

Version: U

### Illustrations

Dimensional drawing

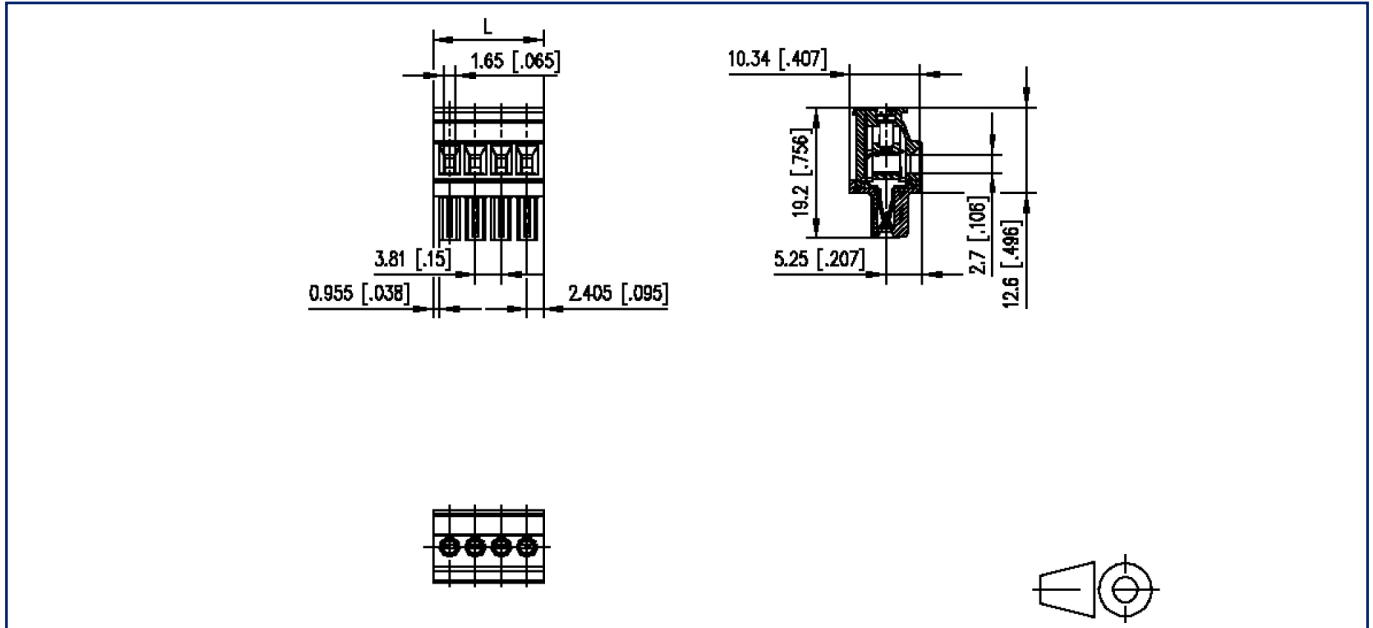

$L = (\text{pole size} - 1) \times \text{centerline} + 4.81 \text{ mm} [0.189]$