

# Data sheet

## RT11LxxHGLU Type 701

### Illustrations



Dimensional drawing

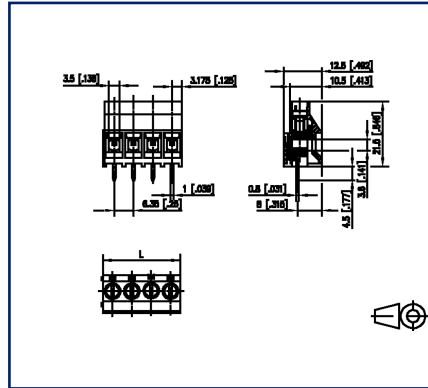

Drill pattern

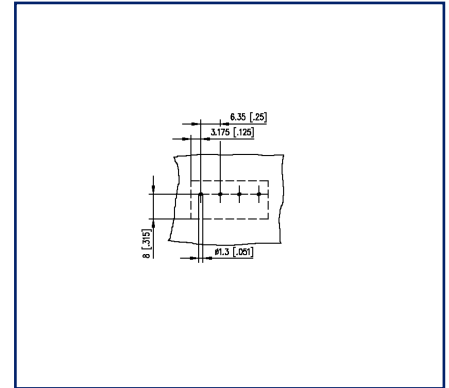



See enlarged drawings at the end of document

### Product specification

- screw type terminal block, solderable
- centerline 6.35 mm, direction of connection 90°
- lift system, modular
- color green



## Technical Data

| General Data  |   |        |        |
|---|---|--------|--------|
| Tightening torque SEV   | 0.6 Nm  |        |        |
| Tightening torque UL  | 5.3 lb-in   |        |        |
| Solder pin length   | 4.5 mm  |        |        |
| min. number of poles  | 2   |        |        |
| max. number of poles  | 3   |        |        |
| Insulating material class   | CTI 600   |        |        |
| clearance/creepage dist.  | 5 mm  |        |        |
| Protection category   | IP20  |        |        |
| Min. insul. strip length  | 7 mm  |        |        |
| Rated current   | 36 A  |        |        |
| Overvoltage category  | III   | III    | II     |
| Pollution degree  | 3   | 2      | 2      |
| Rated voltage   | 200 V   | 500 V  | 500 V  |
| Rated test voltage  | 2.5 kV  | 2.5 kV | 2.5 kV |
| Terminal data   |   |        |        |
| rat.wiring solid AWGmax   | 0.2 mm <sup>2</sup> - 4 mm <sup>2</sup> / AWG 26 - AWG 10 |        |        |
| rat.wiring strand.AWGmax  | 0.2 mm <sup>2</sup> - 4 mm <sup>2</sup> / AWG 26 - AWG 10 |        |        |
| Approvals   |   |        |        |
|  V / A / AWG       | 300 / 30 / 26 - 10  |        |        |
| approval UL - File No.  | E121004   |        |        |
|  4 mm <sup>2</sup> | 450 V / 32 A / T60  |        |        |
| Material  |   |        |        |
| insulating material   | PA66  |        |        |
| flammability class  | V0  |        |        |
| contact material  | CuZnPb  |        |        |
| Contact surface   | Ni + Sn   |        |        |
| terminal body thread  | M3  |        |        |
| terminal body material  | CuZnPb  |        |        |
| terminal body surface   | Ni  |        |        |
| screw thread  | M3  |        |        |

**Data sheet**  
**RT11LxxHGLU Type 701**

Page 3/5

P/N  
317011xx

xx=number of poles

2023/06/28

Version: AE

**Technical Data**

|                             |                               |
|-----------------------------|-------------------------------|
| screw material              | 8,8                           |
| screw surface               | Zn Cr(VI)-frei/free           |
| Glow-Wire Flammability GWFI | 960 °C acc. to IEC 60695-2-12 |
| Glow-Wire Flammability GWIT | 775 °C acc. to IEC 60695-2-13 |

**Climatic Data**

|                         |        |
|-------------------------|--------|
| upper limit temperature | 105 °C |
| lower limit temperature | -40 °C |

**general**

|               |                                     |
|---------------|-------------------------------------|
| Tolerance     | ISO 2768 -mH                        |
| Solderability | Acc. to JEDEC JESD22-B102E 245°C/5s |

## Illustrations

Dimensional drawing

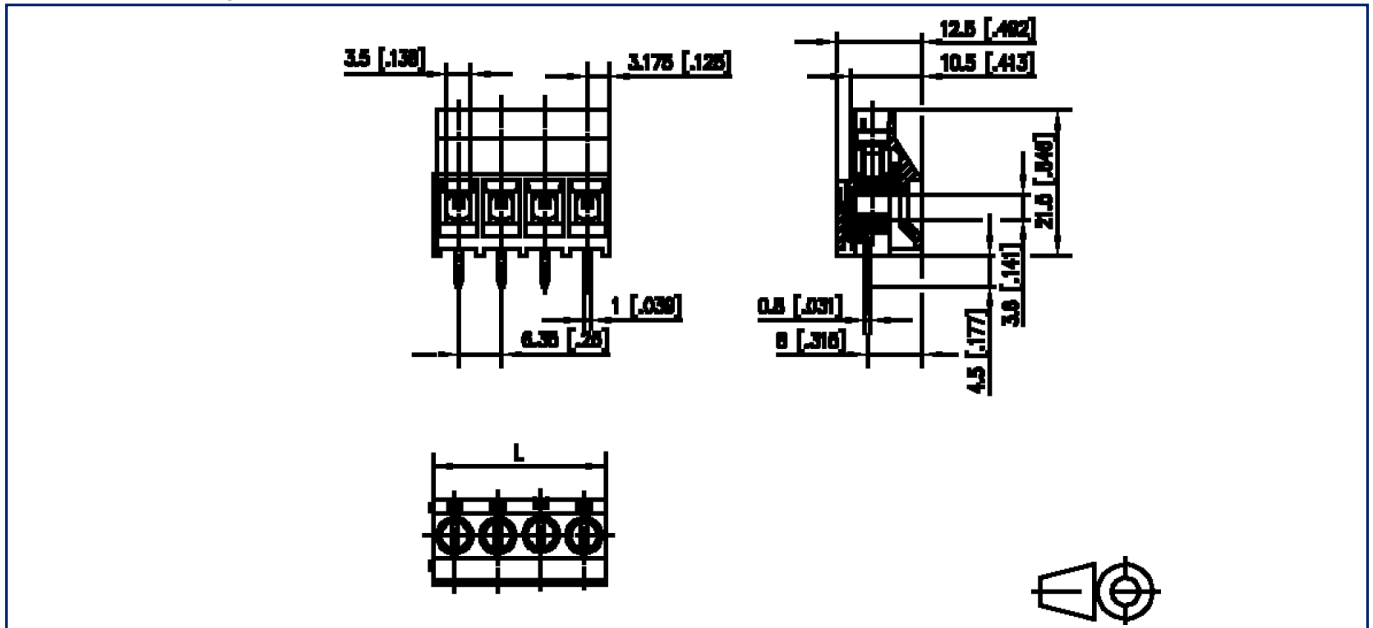

$L = (\text{pole size} - 1) \times \text{centerline} + 6.35 \text{ mm} [0.25]$

## Illustrations

### Drill pattern

