

**MATERIAL:**

- HOUSING—DSM STANYL TE250F6 (NYLON-46)  
HEAT DEFLECTION TEMP.290°  
BLACK COLOR, UL94V-0
- CONTACTS—0.35mm THICK PHOS-BRONZE PLATED  
WITH HARD GOLD AND GOLD FLASH IN  
SOLDER AREA.

CAVITY CONFIRMS TO FCC RULES AND REGULATIONS  
PART 68,SUBPART F.

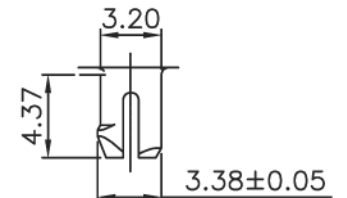
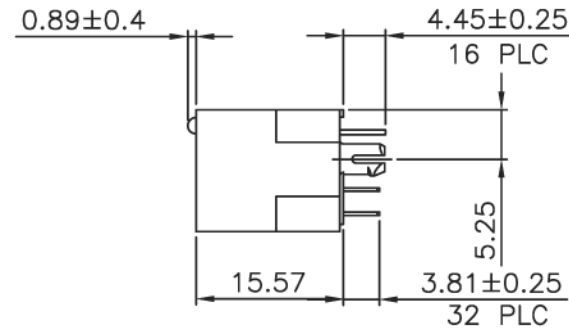
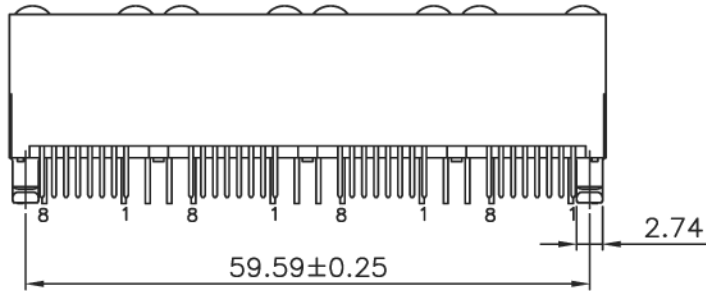

**DETAIL Y**

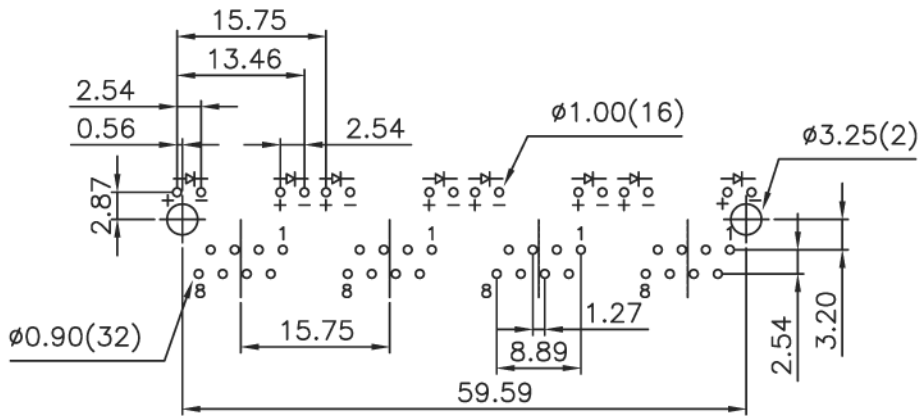

**PCB LAYOUT**

Ref.

**Ordering Information**

AJT32L 8 8 4 X-0 X 0

Type Positions Contacts Ports Plating  
1 = 6u"  
3 = 30u"

	LED1	LED2		LED1	LED2
1=	Yellow	Green	5=	Green	Red
2=	Green	Green	6=	Red	Green
3=	Green	Yellow	7=	Yellow	Yellow
4=	Green	Orange	8=	Grn/Ylw	Grn/Ylw

**Tolerance**  
unless otherwise specified  
.0 ± .25  
.00 ± .20  
.000 ± .10



P/N: AJT32L884X-0X0

Desc.: Top entry, unshielded, LED, thru hole modular jack

Date: 10-18-11

Dimensions in mm Drawn By: Donna Mears