

ISC	M12
PIN #	PIN #
1	4
2	3
GND	5
	1&2 NOT USED

REVISIONS			
REV.	DESCRIPTION	DATE	APPROVED
A	INITIAL RELEASE	6/15/2006	

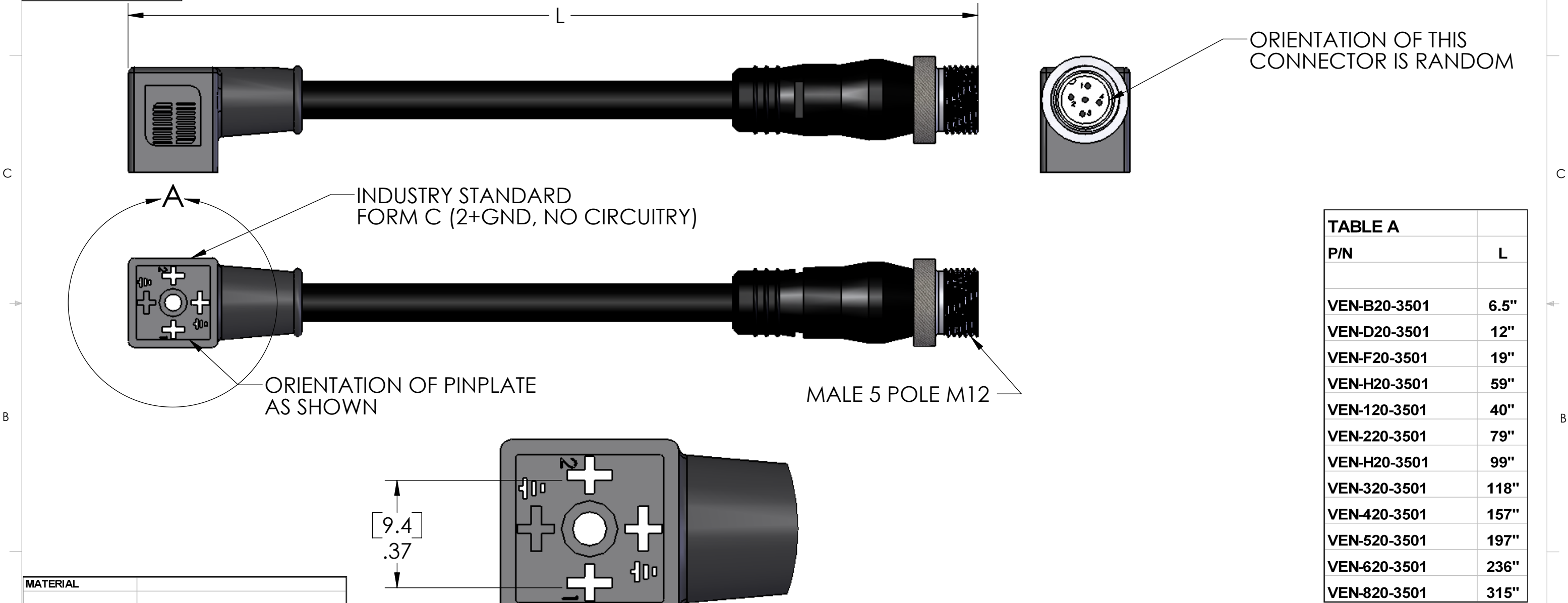
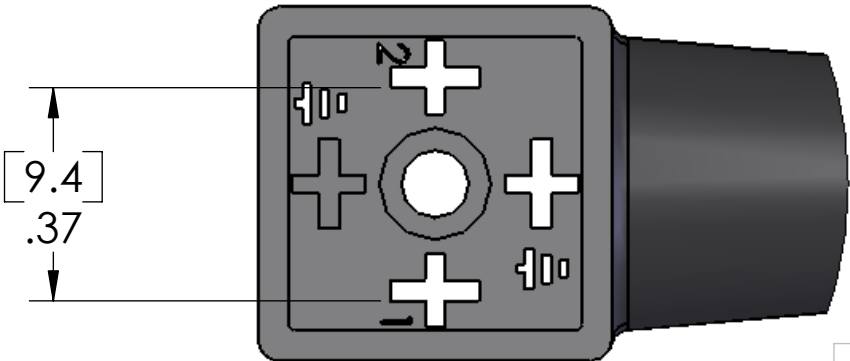

TABLE A	
P/N	L
VEN-B20-3501	6.5"
VEN-D20-3501	12"
VEN-F20-3501	19"
VEN-H20-3501	59"
VEN-120-3501	40"
VEN-220-3501	79"
VEN-H20-3501	99"
VEN-320-3501	118"
VEN-420-3501	157"
VEN-520-3501	197"
VEN-620-3501	236"
VEN-820-3501	315"

MATERIAL	
DIN CONNECTOR	
BODY:	BLACK POLYAMIDE
CONTACTS:	COPPER ALLOY W/ SILVER PLATED
GASKET:	THERMOPLASTIC
SCREW:	STEEL ZINC PLATE
MDC CONNECTOR	
BODY:	BLACK PVC
CONTACTS:	COPPER ALLOY W/ GOLD PLATING
COUPLING NUT:	NICKEL PLATED BRASS
O-RING:	BUNA-N
CABLE:	BLACK PVC, 4 X 18 AWG
IP65	



DETAIL A
SCALE 3 : 1

PROPRIETARY AND CONFIDENTIAL
THE INFORMATION CONTAINED IN THIS DRAWING IS THE SOLE PROPERTY OF MENCOM CORPORATION. ANY REPRODUCTION IN PART OR AS A WHOLE WITHOUT THE WRITTEN PERMISSION OF MENCOM CORPORATION IS PROHIBITED.

UNLESS OTHERWISE SPECIFIED:		NAME	MENCOM CORPORATION	
DIMENSIONS ARE IN INCHES AND [MM]		DRAWN	CAM	TITLE:
		CHECKED		
		ENG APPR.		
		MFG APPR.		
		Q.A.		
		COMMENTS:		
VOLTS	250V		SIZE	DWG. NO.
AMPS	4A		B	VEN-ZZ20-3501
TEMP	60°C			REV
				A
DO NOT SCALE DRAWING			SCALE: 3:2	WEIGHT:
				SHEET 1 OF 1