

8 7 6 5 4 3 2 1

D

C

B

A

D

C

B

A

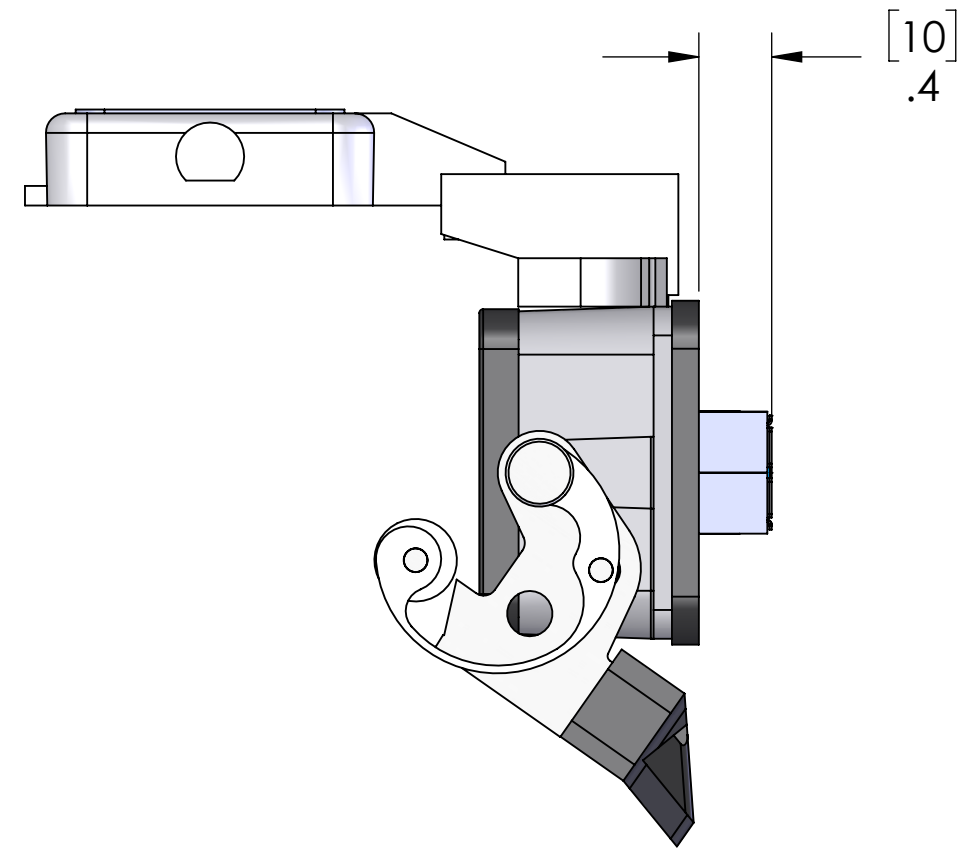
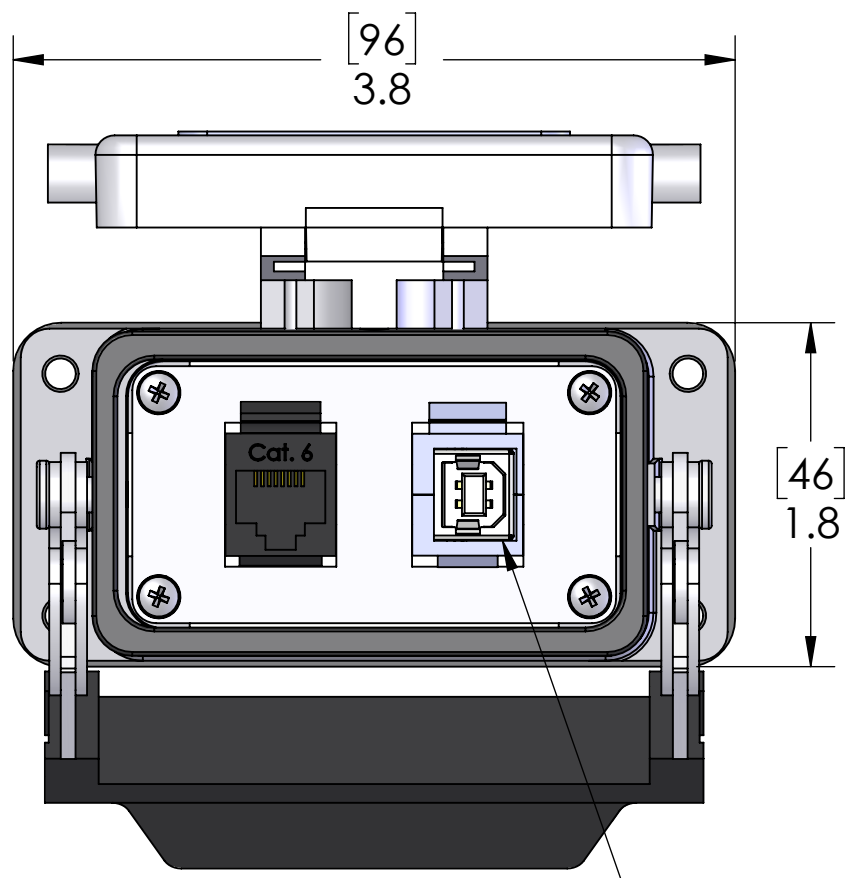

USB TYPE B FEMALE (EXTERIOR)  
TO TYPE A FEMALE (INTERIOR)

PANEL CUTOUT

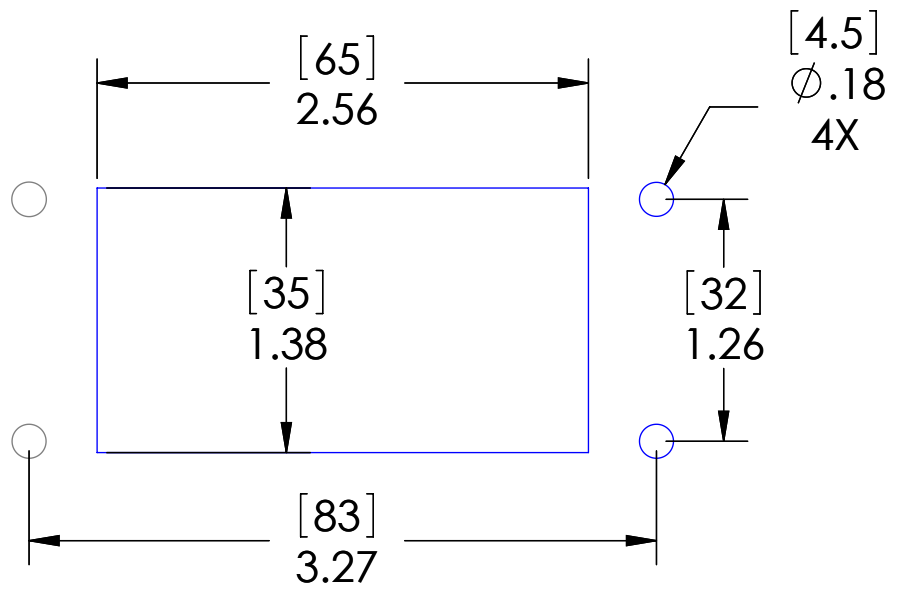

OPERATING TEMPERATURE: (-10°C / +60° C (+14° F / +140° F ))  
MOUNTING KIT ORDERED SEPARATELY CONTAINS  
M4x0.7 SS SCREW, NYLON WASHER,  
SPLIT LOCKWASHER AND M4 NUT  
P/N: D-PIC-MT

HOUSING MATERIALS	
BODY:	EPOXY COATED DIE CAST ALUMINUM
GASKET:	THERMOPLASTIC ELASTOMER
HANDLE:	POLYAMIDE
LEVERS:	STAINLESS STEEL



UNLESS OTHERWISE SPECIFIED:	
DIMENSIONS ARE IN INCHES AND [MM]	
MATERIAL	
FINISH	
DO NOT SCALE DRAWING	

These devices shall be mounted on enclosures having adequate strength and thickness and with adequate spacing provided. Seal rating is based on mounting to a surface that is clean, flat and smooth.

PIC RATINGS/SPECIFICATIONS	
NEMA/UL   EN 60529:	4, 4X, 12   IP65
MOUNTING SCREW SIZE:	M4 (8-32) (304 or 316SS for 4X)
MOUNTING SCREW TORQUE:	1.2~1.8N-m (0.9~1.3 Lb-Ft)

DRAWN BY	GO
DRAWN DATE	07/12/2021
CHECKED BY	DCG
CHECK DATE	07/14/2021

MENCOM CORPORATION

TITLE:  
SZ10 RJ45; USB B-A

COMMENTS:

STANDARD CONFIGURATIONS UNLESS OTHERWISE NOTED		
CONN. TYPE	EXTERIOR	INTERIOR
RJ45	CAT. 6 JACK	CAT. 6 JACK

PROPRIETARY AND CONFIDENTIAL  
THE INFORMATION CONTAINED IN THIS DRAWING IS THE SOLE PROPERTY OF MENCOM CORPORATION. ANY REPRODUCTION IN PART OR AS A WHOLE WITHOUT THE WRITTEN PERMISSION OF MENCOM CORPORATION IS PROHIBITED.

SIZE	DWG. NO.	REV
B	RJ45-USB-BFAF-10	B
SCALE: 1:1	WEIGHT:	SHEET 1 OF 1

8 7 6 5 4 3 2 1