

NOTE: FOR USE WITH
MENCOM CORP
RJ CABLE
RJ45-03
RJ45-10
RJ45-15

REVISIONS			
REV.	DESCRIPTION	DATE	APPROVED
A	REDRAWN IN SW	9/15/2005	BEM

C

B

A

PANEL CUTOUT

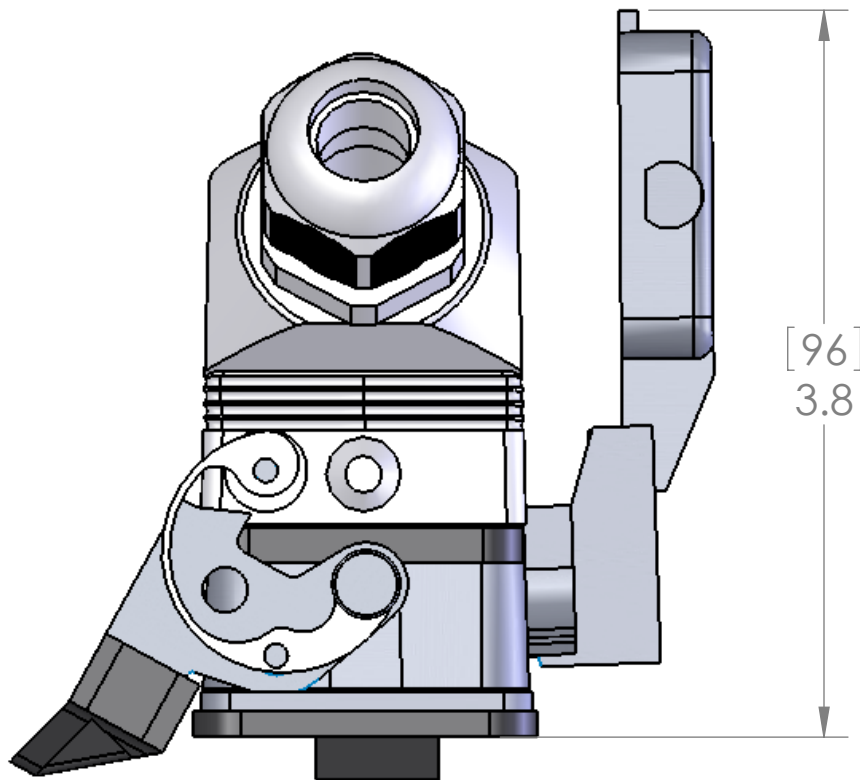
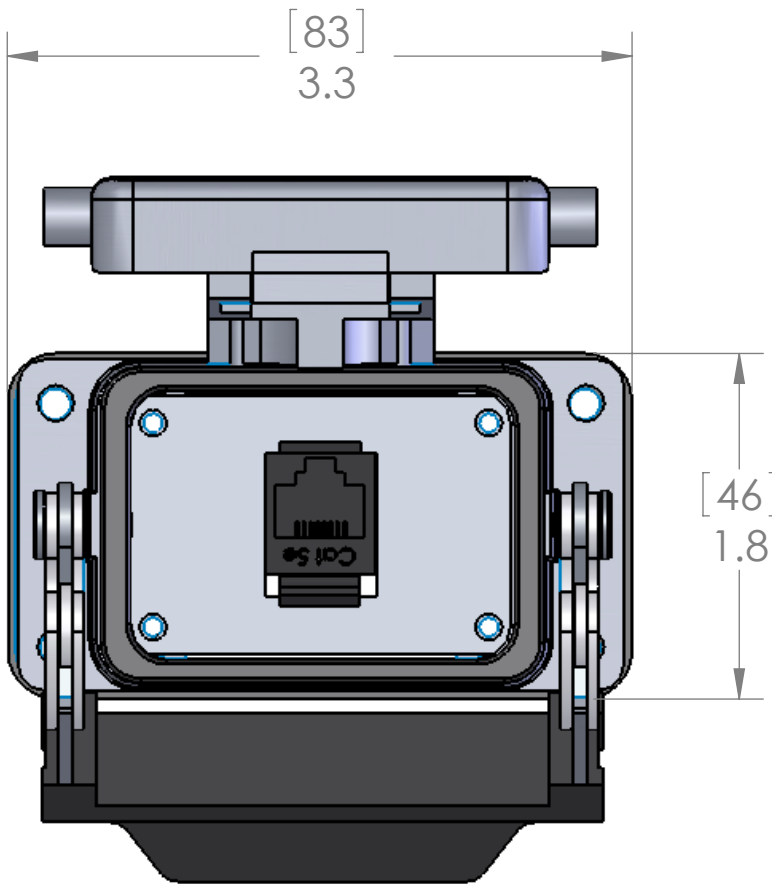
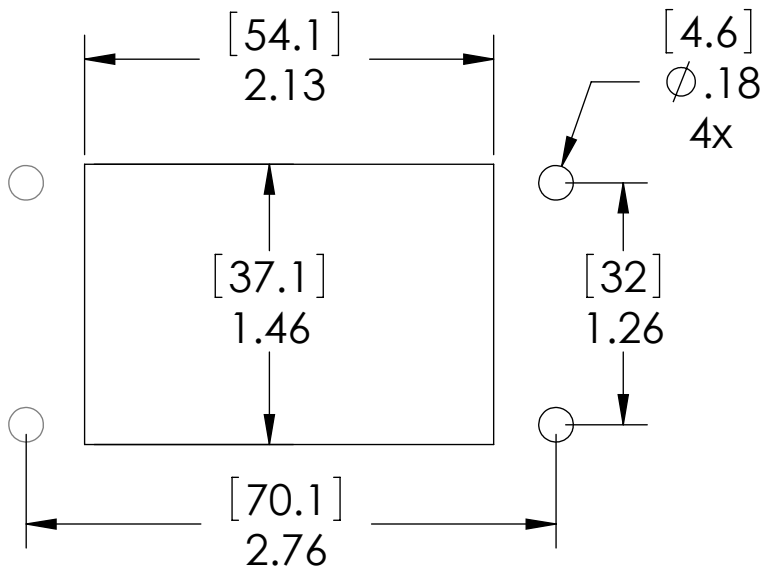

HOUSING MATERIALS	
BODY:	EPOXY COATED DIE CAST ALUMINUM
GASKET:	THERMOPLASTIC ELASTOMER
HANDLE:	POLYAMIDE
LEVERS:	STAINLESS STEEL

STANDARD CONFIGURATIONS UNLESS OTHERWISE NOTED		
CONN. TYPE	EXTERIOR	INTERIOR
RJ45	CAT 5 JACK	CAT 5 JACK

PIC RATINGS	
NEMA/UL:	4, 4X, 12

PROPRIETARY AND CONFIDENTIAL
THE INFORMATION CONTAINED IN THIS
DRAWING IS THE SOLE PROPERTY OF
MENCOM CORPORATION. ANY
REPRODUCTION IN PART OR AS A WHOLE
WITHOUT THE WRITTEN PERMISSION OF
MENCOM CORPORATION IS
PROHIBITED.

UNLESS OTHERWISE SPECIFIED:	
DIMENSIONS ARE IN INCHES AND [MM]	
MATERIAL	DO NOT SCALE DRAWING
FINISH	

MENCOM CORPORATION		
TITLE:		
SIZE	DWG. NO.	REV
B	RJ45-CKIT	A
SCALE: 1:1	WEIGHT:	SHEET 1 OF 1