

WIRING				
CONN 1		CONN 2		CONN 3
1	---	1	---	1
2	---	2	---	2
3	---	3	---	3
4	---	4	---	4

DEVICE IS INTENDED TO BE WIRED WITH CONDUCTORS RATED AT 75°C OR HIGHER

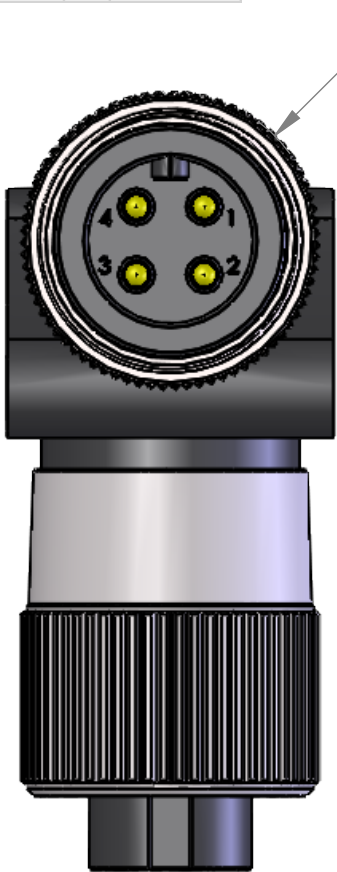

[39]
Ø 1.6

[103]
4.0

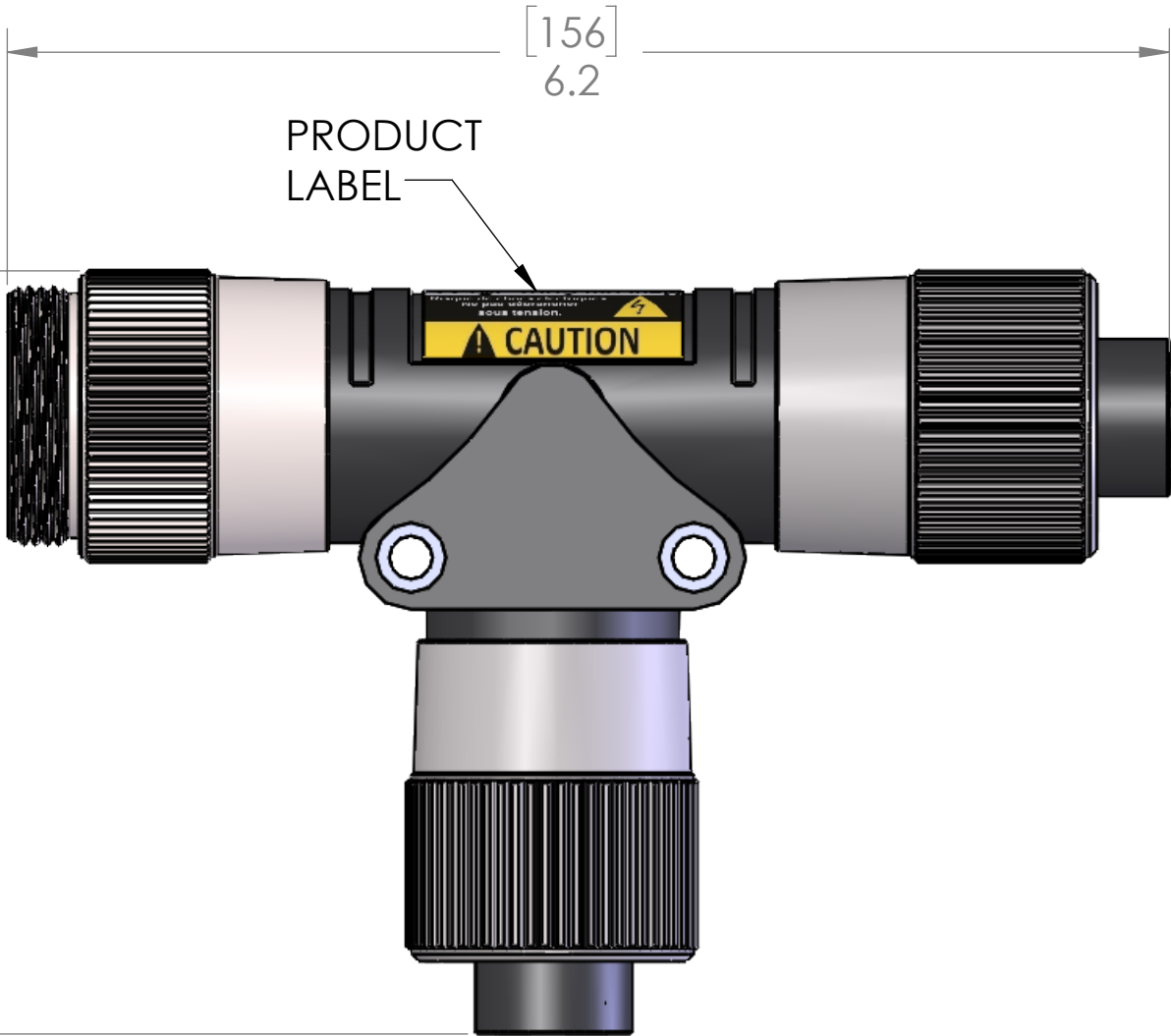

PRODUCT LABEL

[156]
6.2

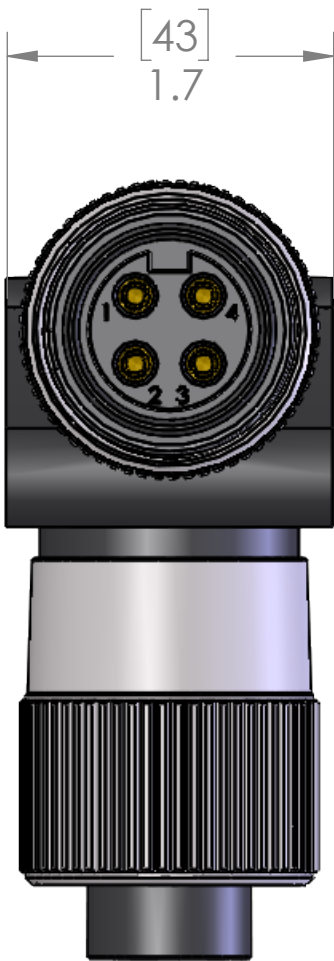

[43]
1.7

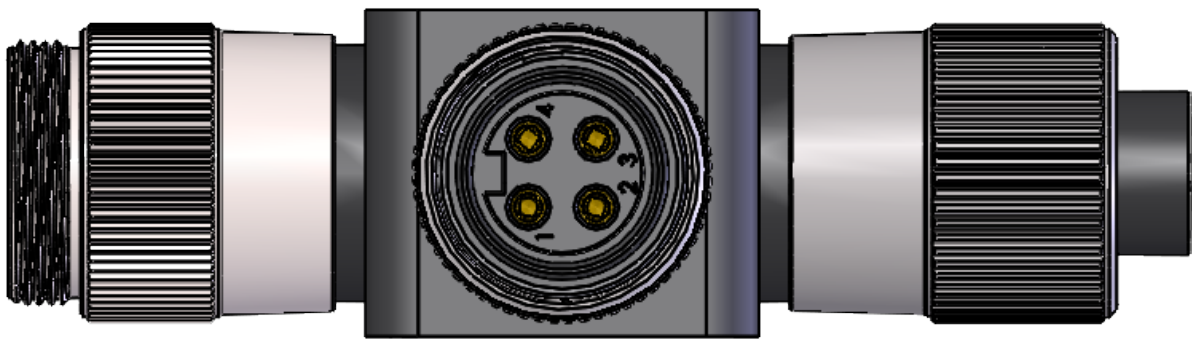

ALL THREADS 1.375-16UN

MATERIALS	
BODY:	BLACK PVC
CONTACTS:	GOLD PLATED COPPER ALLOY
COUPLING:	NICKEL PLATED BRASS
INSERT:	BLACK PVC
RATINGS	
SCCR RATING:	65 kA Breakers and Fuses
RoHS COMPLIANT:	YES
PROTECTION:	IEC IP67
UL CATEGORY:	PVVA (US), PVVA7 (Canada)
U.S.:	UL 2237 LISTED, File E469485
CANADA:	C-UL 2237 LISTED, File E469485

PROPRIETARY AND CONFIDENTIAL
THE INFORMATION CONTAINED IN THIS DRAWING IS THE SOLE PROPERTY OF MENCOM CORPORATION. ANY REPRODUCTION IN PART OR AS A WHOLE WITHOUT THE WRITTEN PERMISSION OF MENCOM CORPORATION IS PROHIBITED.

VOLTS 600V
AMPS 40A
TEMP: -40° to 90°C

UNLESS OTHERWISE SPECIFIED:	DRAWN BY	
DIMENSIONS ARE IN INCHES AND [MM]	DRAWN DATE	02/19/2024
	CHECKED BY	JJH
	CHECK DATE	02/19/2024
MATERIAL	COMMENTS:	
FINISH		
DO NOT SCALE DRAWING		



CAUTION:
RISK OF ELECTRICAL SHOCK
DO NOT DISCONNECT UNDER LOAD

MENCOM CORPORATION

TITLE:
4 PL M-F-F PMIN T

SIZE	DWG. NO.	REV
B	PMIN-40MFF-T	C
SCALE: 1:1	WEIGHT:	SHEET 1 OF 1