

REVISIONS			
REV.	DESCRIPTION	DATE	APPROVED
A	DRAWN IN SW	1/14/2016	JHH
B	UPDATED CAD	4/15/2016	BEM

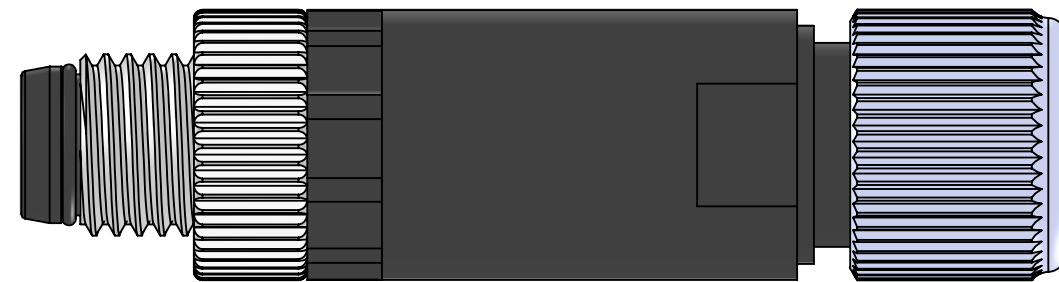
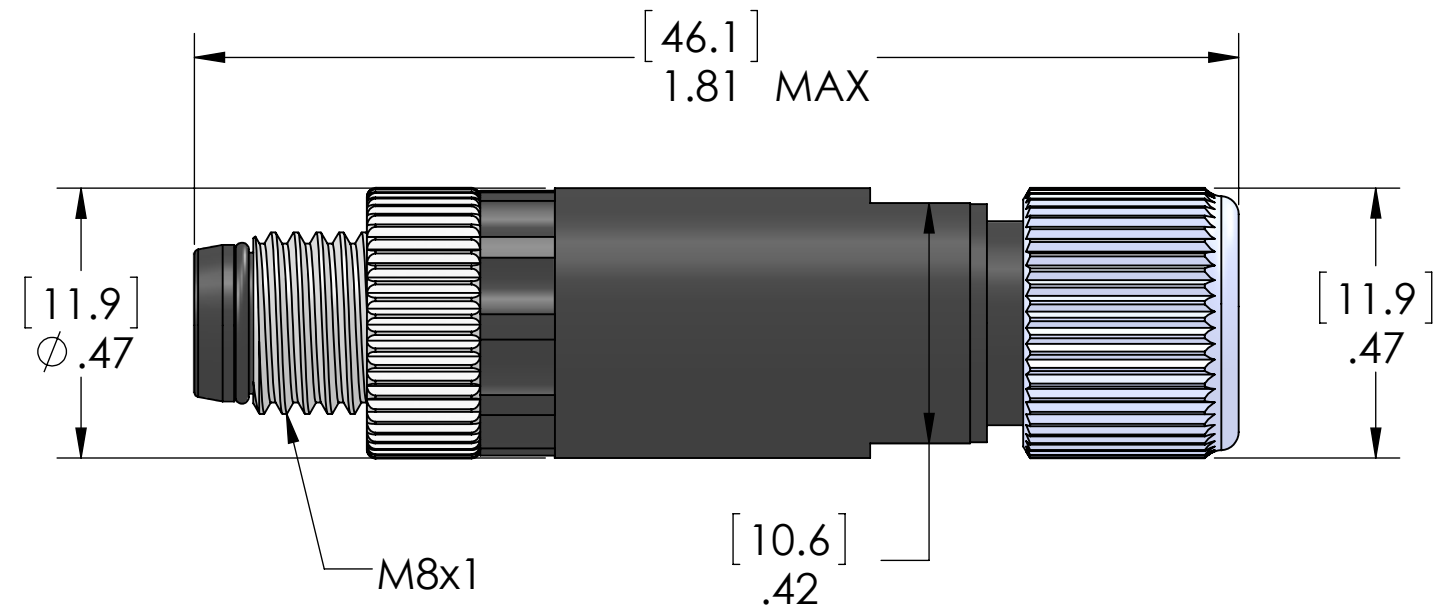
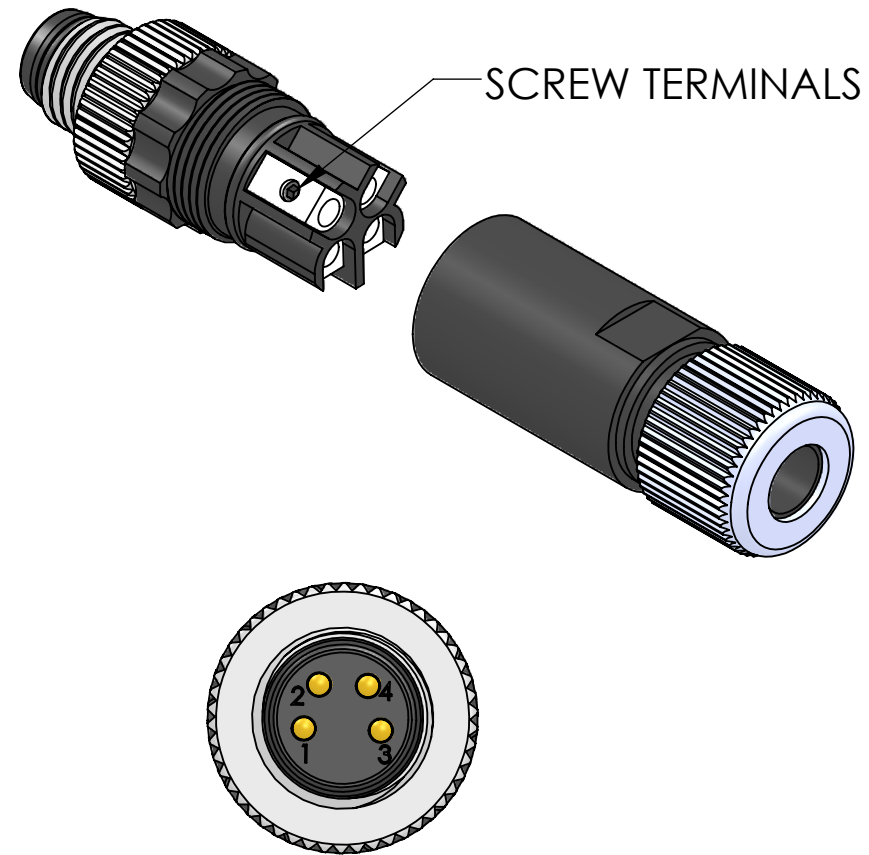

MATERIALS:	
BODY:	POLYAMIDE
COUPLINGS:	NICKEL PLATED BRASS
CONTACTS:	GOLD PLATED COPPER ALLOY
GROMMET:	NBR
O-RING:	NBR
SPECIFICATIONS:	
WIRE RANGE:	20-26AWG [0.5 - 0.14sqmm]
CABLE RANGE:	0.118 - 0.197 [3 - 5mm]
CONNECTION:	SCREW TERMINALS
VOLTS:	30V
AMPS:	3A
SEAL:	IP67
TEMP RANGE:	STATIC: -40°C - +85°C
	DYNAMIC: -20°C -+85°C

PROPRIETARY AND CONFIDENTIAL

THE INFORMATION CONTAINED IN THIS
DRAWING IS THE SOLE PROPERTY OF
MENCOM CORPORATION. ANY
REPRODUCTION IN PART OR AS A WHOLE
WITHOUT THE WRITTEN PERMISSION OF
MENCOM CORPORATION IS
PROHIBITED.

		UNLESS OTHERWISE SPECIFIED:		NAME	MENCOM CORPORATION							
		DIMENSIONS ARE IN INCHES AND [MM]	DRAWN	CAM					TITLE: 4 PL SCRW TERM FW NAN			
			CHECKED									
			ENG APPR.									
			MFG APPR.									
			Q.A.		SIZE B							
		MATERIAL	COMMENTS:						DWG. NO.		REV	
		FINISH							NAN-T-4MP-FW-ST		B	
		DO NOT SCALE DRAWING							SCALE: 3:1		WEIGHT:	SHEET 1 OF 1