

PIN #	COLOR	PIN #	COLOR
1	VIOLET	11	BLACK
2	RED	12	GREEN/YELLOW
3	GRAY	13	YELLOW w/BROWN
4	RED w/BLUE	14	BROWN w/GREEN
5	BLUE	15	WHITE
6	GREEN	16	YELLOW
7	BROWN	17	PINK
8	WHITE w/GREEN	18	GRAY w/BROWN
9	WHITE w/YELLOW	19	GRAY w/PINK
10	WHITE w/GRAY		

PINS 5, 7 & 12 ARE 18AWG

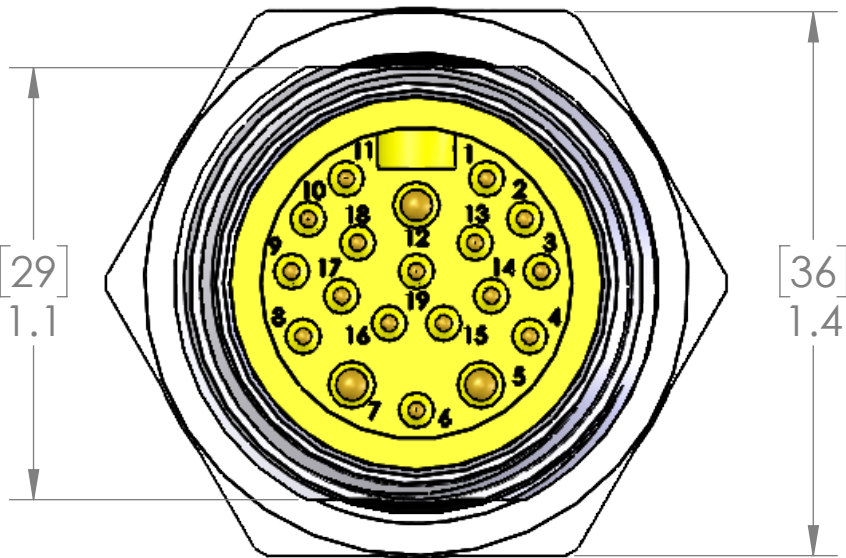
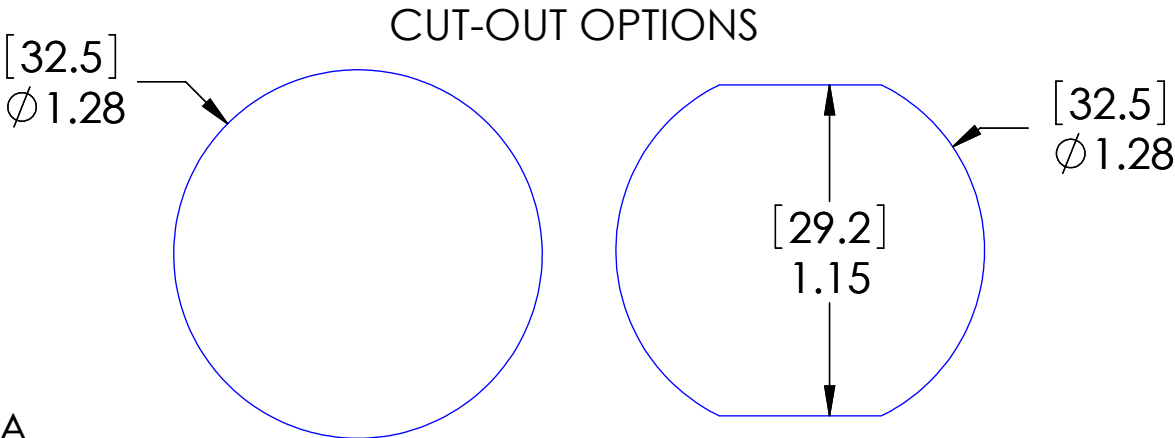
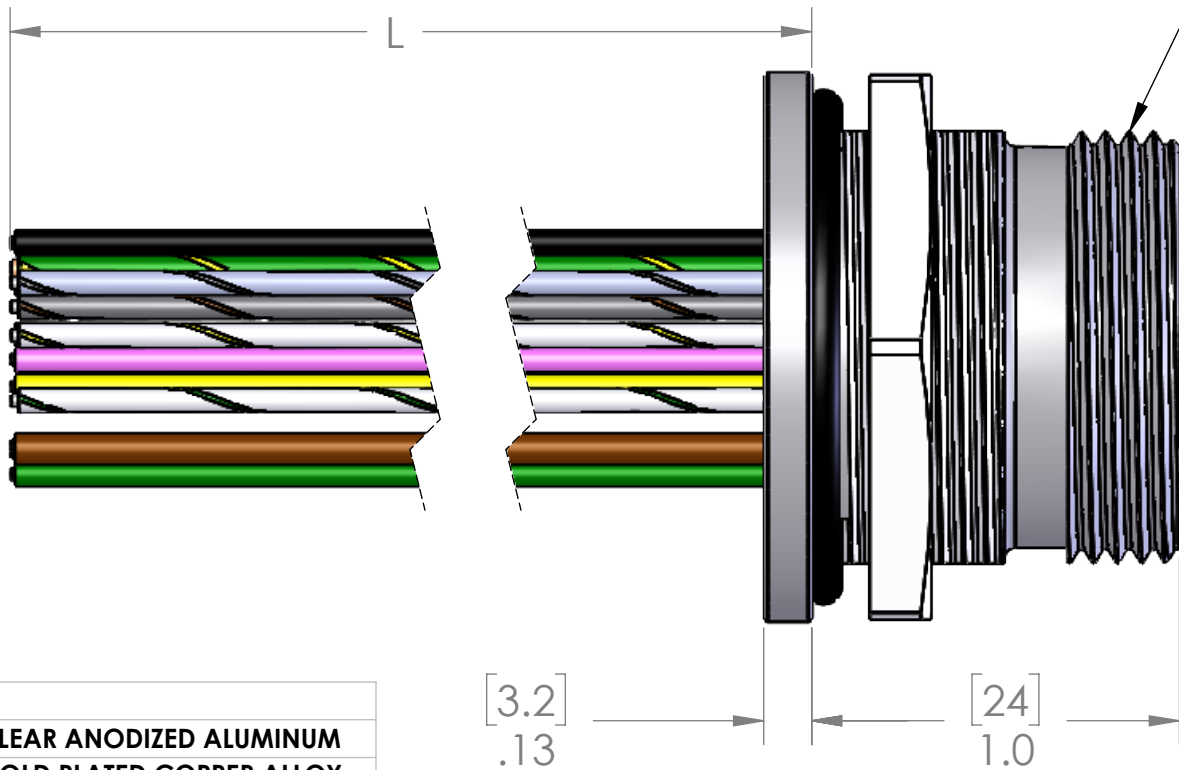

MATERIALS	
SHELL:	CLEAR ANODIZED ALUMINUM
CONTACTS:	GOLD PLATED COPPER ALLOY
WIRES:	
STYLE:	UL 1007/1569
AWG:	18/3 & 22/16
JACKET:	PVC
VOLTAGE:	300V
INSERT:	YELLOW PVC
O-RING:	NBR
NUT:	NICKEL PLATED BRASS
APPROVALS	
US:	UL LISTED
CANADA:	C-UL LISTED
ROHS:	YES
CE:	YES
RATINGS	
PROTECTION CLASS:	IEC IP69

Please note that to better serve the varying needs of our customers, these parts have been UL tested for two different amperage ratings as shown by our Ratings table.

RATINGS:	
PIN 12	GROUND
PINS 5 & 7	300V, 6A
ALL OTHERS	300V, 1A
OR	
PIN 12	GROUND
PINS 5 & 7	300V, 4A
ALL OTHERS	300V, 2A

PROPRIETARY AND CONFIDENTIAL
THE INFORMATION CONTAINED IN THIS DRAWING IS THE SOLE PROPERTY OF MENCOM CORPORATION. ANY REPRODUCTION IN PART OR AS A WHOLE WITHOUT THE WRITTEN PERMISSION OF MENCOM CORPORATION IS PROHIBITED.

VOLTS	300V
AMPS	6A/1A OR 4A/2A
TEMP:	105°C

UNLESS OTHERWISE SPECIFIED:	DRAWN BY	APR
DIMENSIONS ARE IN INCHES AND [MM]	DRAWN DATE	02/28/2024
	CHECKED BY	JJH
	CHECK DATE	02/29/2024
	COMMENTS:	
MATERIAL		
FINISH		
DO NOT SCALE DRAWING		

TABLE A	
P/N	L
MIN-19MR-1-BM	12" [0.3m]
MIN-19MR-2-BM	24" [0.6m]
MIN-19MR-3-BM	36" [0.9m]
MIN-19MR-4-BM	48" [1.2m]
MIN-19MR-6-BM	72" [1.8m]
MIN-19MR-10-BM	120" [3.1m]
MIN-19MR-15-BM	180" [4.6m]
MIN-19MR-20-BM	240" [6.1m]

OTHER LENGTHS AVAILABLE
PLEASE CONSULT FACTORY

MENCOM CORPORATION

TITLE:
19 PL MIN ML RECP

SIZE	DWG. NO.	REV
B	MIN-19MR-ZZ-BM	B
SCALE: 3:2	WEIGHT:	SHEET 1 OF 1