

PIN #	COLOR	PIN #	COLOR
1	GRAY/PINK	8	GREEN
2	WHITE/GREEN	9	PINK
3	WHITE/YELLOW	10	WHITE
4	BROWN	11	RED/BLUE
5	BROWN/YELLOW	12	BROWN/GREEN
6	BLUE	13	GRAY
7	YELLOW	14	RED

BROWN AND BLUE ARE 18AWG [1.0 sqmm] WIRES
ALL OTHERS ARE 22AWG [0.34sqmm] WIRES

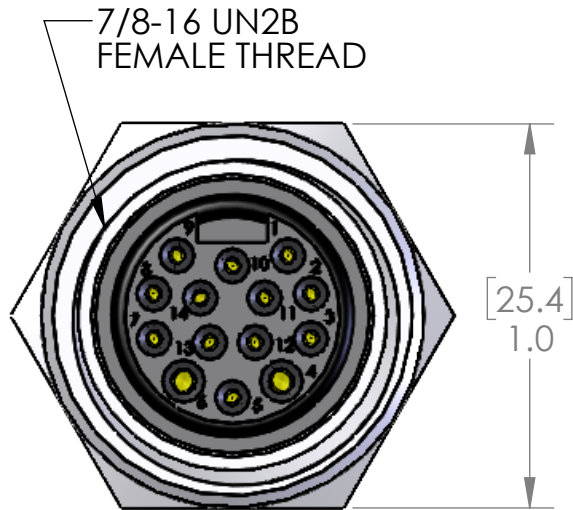

MATERIALS	
SHELL:	CLEAR ANODIZED ALUMINUM
CONTACTS:	GOLD PLATED COPPER ALLOY
WIRES:	
STYLE:	UL 1007/1569
AWG:	18 & 22 AWG
JACKET:	PVC
VOLTAGE:	300V
INSERT:	BLACK PVC
O-RING:	NBR
NUT:	ZINC PLATED STEEL
APPROVALS	
US:	UL LISTED
CANADA:	C-UL LISTED
ROHS:	YES
CE & UKCA:	YES
RATINGS	
PROTECTION CLASS:	UL TYPE 4 & 12, IEC IP69

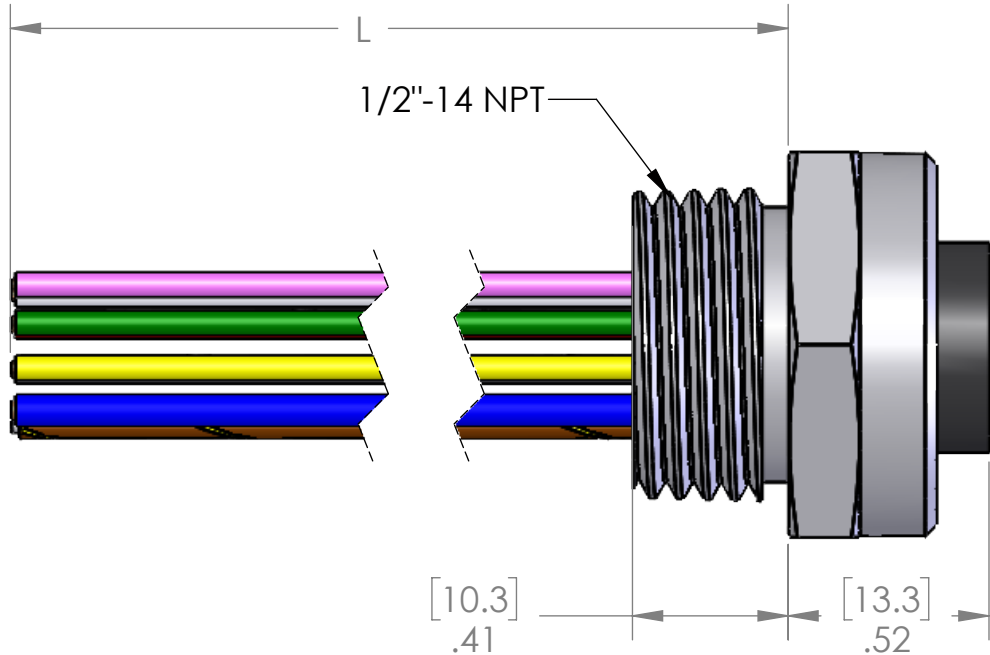
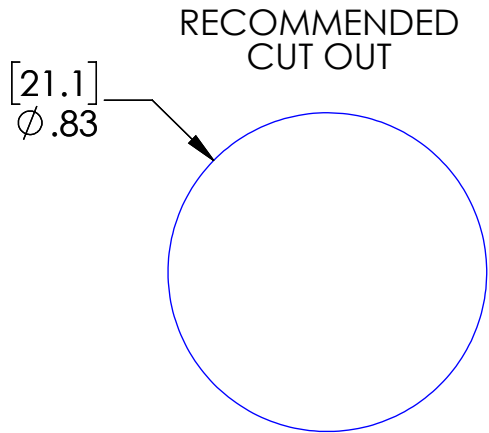

AN O-RING AND LOCKNUT ARE INCLUDED
ON LENGTHS OF 24" [0.6M] AND LONGER.

PROPRIETARY AND CONFIDENTIAL
THE INFORMATION CONTAINED IN THIS
DRAWING IS THE SOLE PROPERTY OF
MENCOM CORPORATION. ANY
REPRODUCTION IN PART OR AS A WHOLE
WITHOUT THE WRITTEN PERMISSION OF
MENCOM CORPORATION IS
PROHIBITED.

VOLTS	150V
AMPS	6A / 1A
TEMP:	105°C

UNLESS OTHERWISE SPECIFIED:		DRAWN BY	ADM
DIMENSIONS ARE IN INCHES AND [MM]		DRAWN DATE	01/16/2024
		CHECKED BY	JJH
		CHECK DATE	01/19/2024
		COMMENTS:	
MATERIAL			
FINISH			
DO NOT SCALE DRAWING			

TABLE A	
P/N	L
MIN-14FR-1	12" [305]
MIN-14FR-1M	40" [1M]
MIN-14FR-2M	79" [2M]
MIN-14FR-3M	118" [3M]
MIN-14FR-4M	157" [4M]
MIN-14FR-6M	240" [6M]

OTHER LENGTHS ARE AVAILABLE
PLEASE CONSULT FACTORY

MENCOM CORPORATION			
TITLE:			
SIZE	DWG. NO.		REV
B	MIN-14FR-ZZ		B
SCALE: 2:1		WEIGHT:	SHEET 1 OF 1