

REVISIONS			
REV.	DESCRIPTION	DATE	APPROVED
A	Redrawn in SW	8/4/2014	JJH

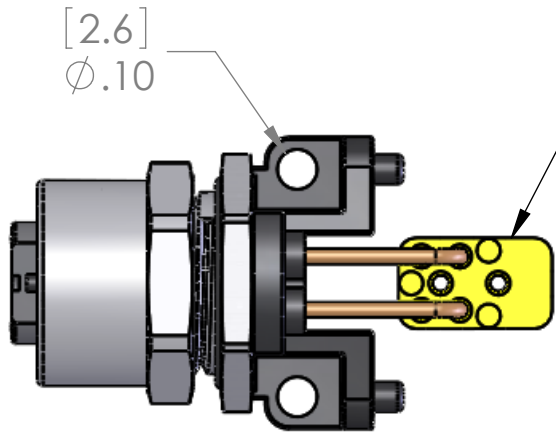

PC Tail Guard is shipped with each part to protect part during shipping. part may be left on or removed when installing.

Recommended MAX
Panel Thickness: .125" max

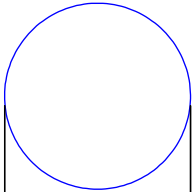

Typical Panel
Cutout

[12.30]
Ø.48

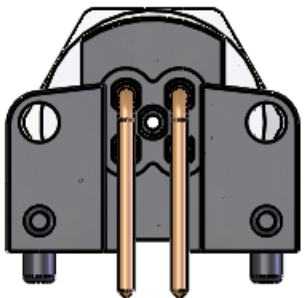
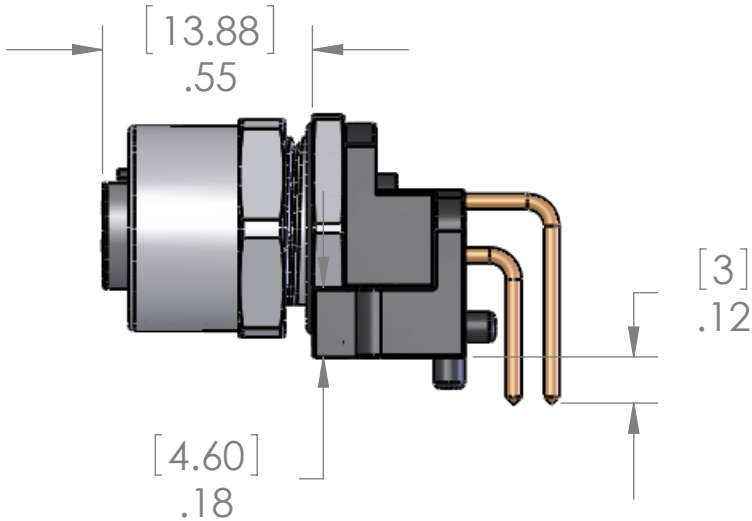
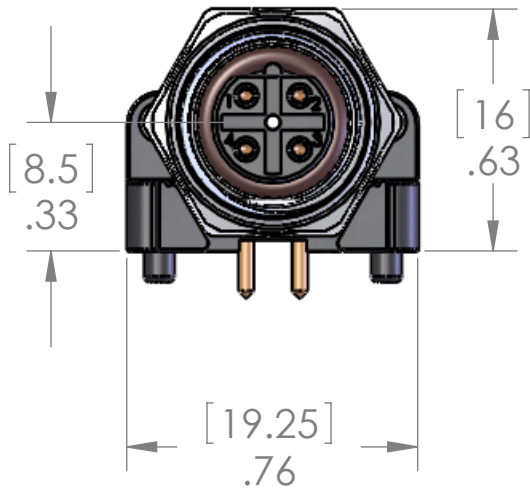

[2]
Ø.08

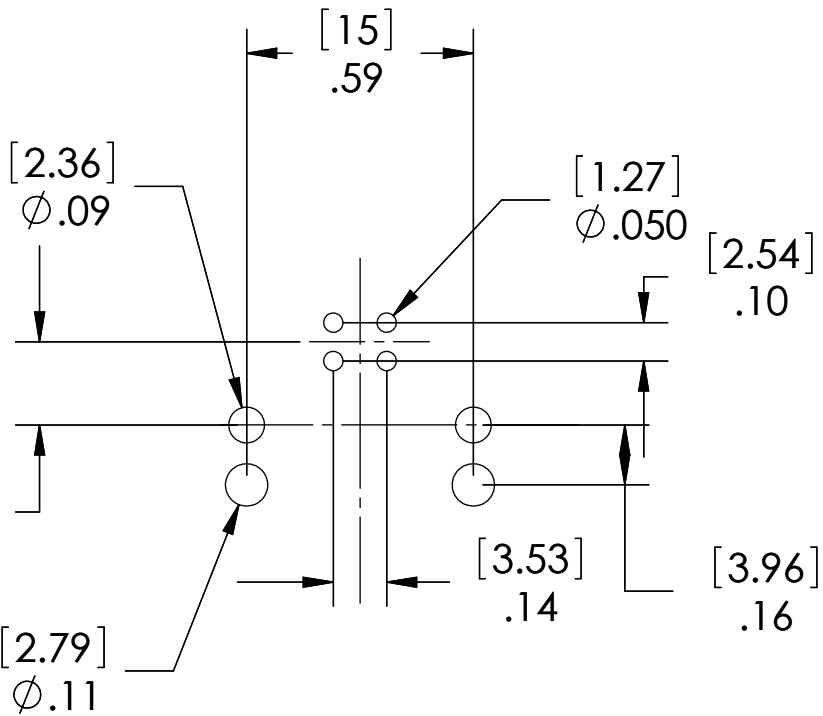
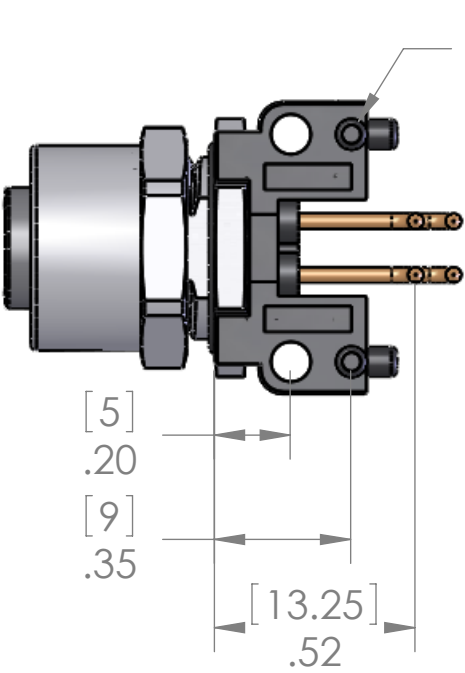

MATERIALS:	
BODY:	POLYAMIDE
METAL HDWR:	NICKEL PLATED BRASS
CONTACTS:	GOLD PLATED COPPER ALLOY
O-RING:	BUNA-N
RATINGS:	
VOLTAGE:	250V
AMPERAGE:	4A
CERTIFICATIONS:	
US:	UL LISTED
CANADA:	C-UL LISTED

PROPRIETARY AND CONFIDENTIAL
THE INFORMATION CONTAINED IN THIS DRAWING IS THE SOLE PROPERTY OF MENCOM CORPORATION. ANY REPRODUCTION IN PART OR AS A WHOLE WITHOUT THE WRITTEN PERMISSION OF MENCOM CORPORATION IS PROHIBITED.

UNLESS OTHERWISE SPECIFIED:		NAME	MENCOM CORPORATION	
DIMENSIONS ARE IN INCHES AND [MM]		DRAWN	BEM	TITLE:
		CHECKED		4 PL R/A FEM RECP
		ENG APPR.		
		MFG APPR.		
		Q.A.		
MATERIAL		COMMENTS:		SIZE
FINISH				DWG. NO.
DO NOT SCALE DRAWING				MEC-4FR-PCB-R
				REV
				A
		SCALE: 2:1	WEIGHT:	SHEET 1 OF 1