

REVISIONS			
REV.	DESCRIPTION	DATE	APPROVED
A	REDRAWN IN SW	8/6/2008	

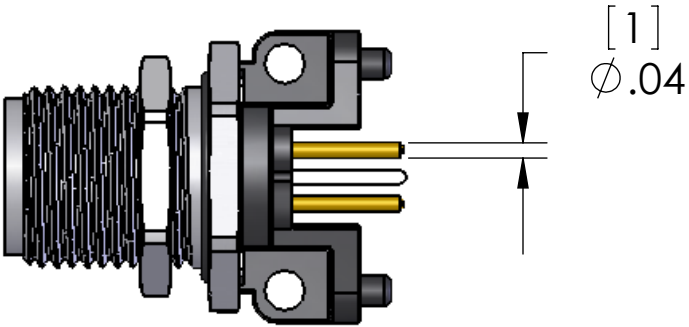

Recommended MAX Panel Thickness: 0.12" [3mm]
Recommended PCB thickness: 0.63" [1.6mm]

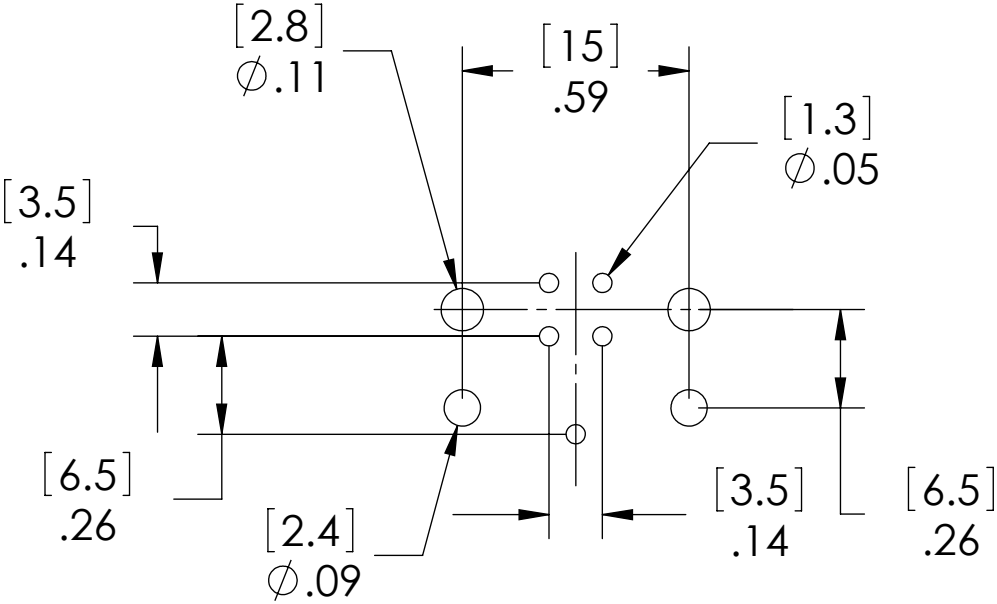
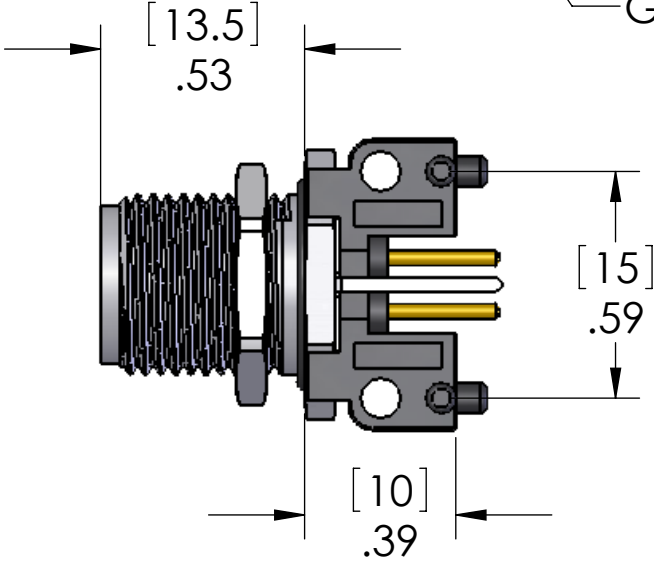
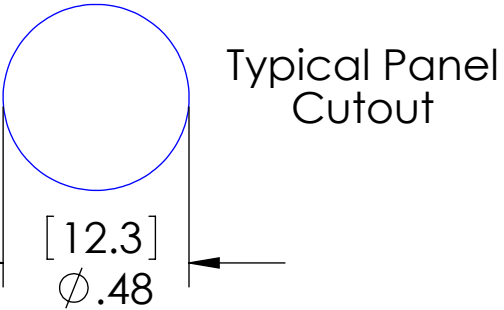
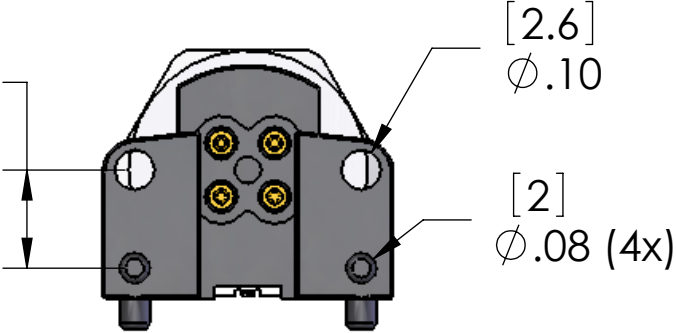
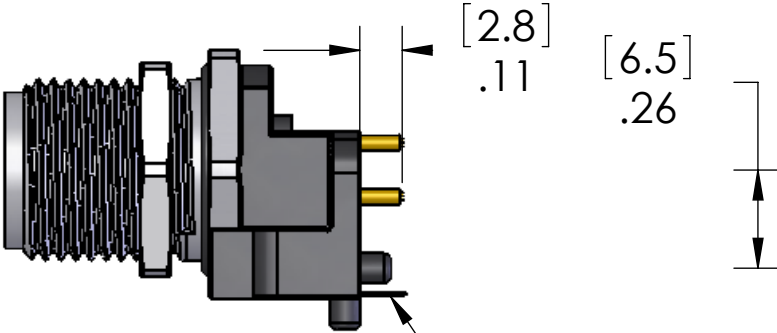
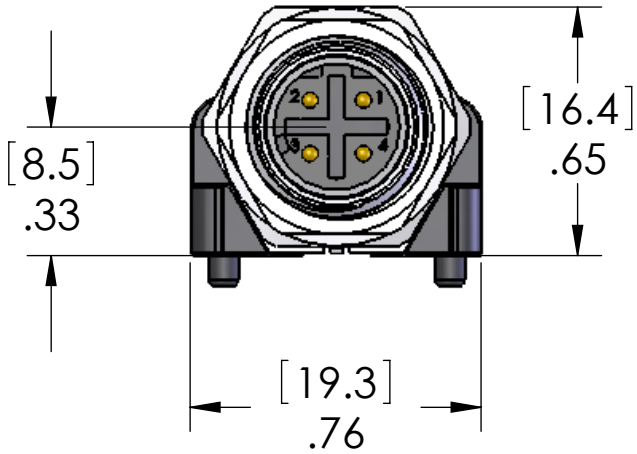

MATERIALS:	
BODY:	POLYAMIDE
METAL HDWR:	NICKEL PLATED BRASS
CONTACTS:	GOLD PLATED COPPER ALLOY
O-RING:	BUNA-N
GROUND TAB:	NICKEL PLATED BRASS
RATINGS:	
VOLTAGE:	250V
AMPERAGE:	4A

PROPRIETARY AND CONFIDENTIAL
THE INFORMATION CONTAINED IN THIS DRAWING IS THE SOLE PROPERTY OF MENCOM CORPORATION. ANY REPRODUCTION IN PART OR AS A WHOLE WITHOUT THE WRITTEN PERMISSION OF MENCOM CORPORATION IS PROHIBITED.

UNLESS OTHERWISE SPECIFIED:		NAME	MENCOM CORPORATION	
DIMENSIONS ARE IN INCHES AND [MM]		DRAWN	BEM	TITLE:
		CHECKED		4 Pole Ethernet pcb mt w/grnd tab (D - Coded)
		ENG APPR.		SIZE
		MFG APPR.		DWG. NO.
		Q.A.		REV
		COMMENTS:		A
MATERIAL		SCALE: 2:1		SHEET 1 OF 1
FINISH		WEIGHT:		
DO NOT SCALE DRAWING				