

- 1 = White/Blue

2 = White/Brown

3 = Brown

4 = Orange (- TX)
- 5 = White/Green (+ RX)

6 = White/Orange (+ TX)

7 = Blue

8 = Green (- RX)

REVISIONS			
REV.	DESCRIPTION	DATE	APPROVED
A	REDRAWN IN SW	9/2/2008	

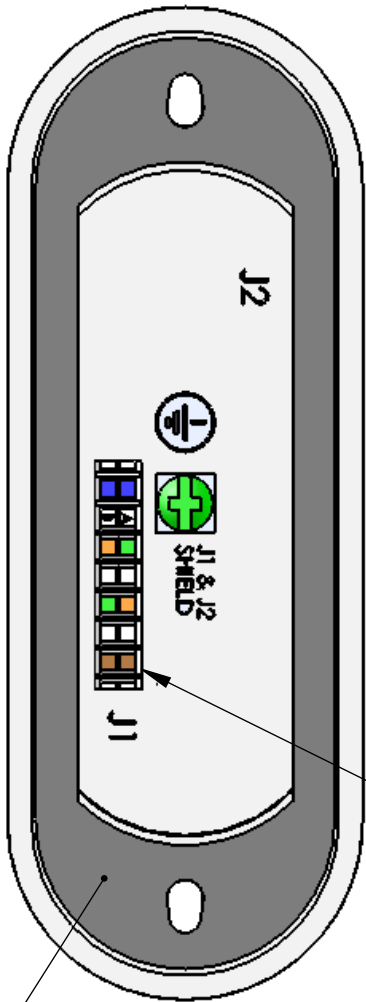
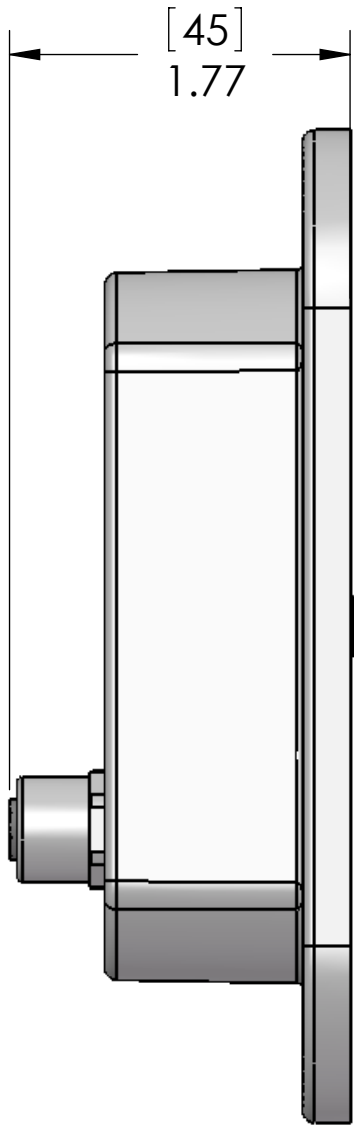
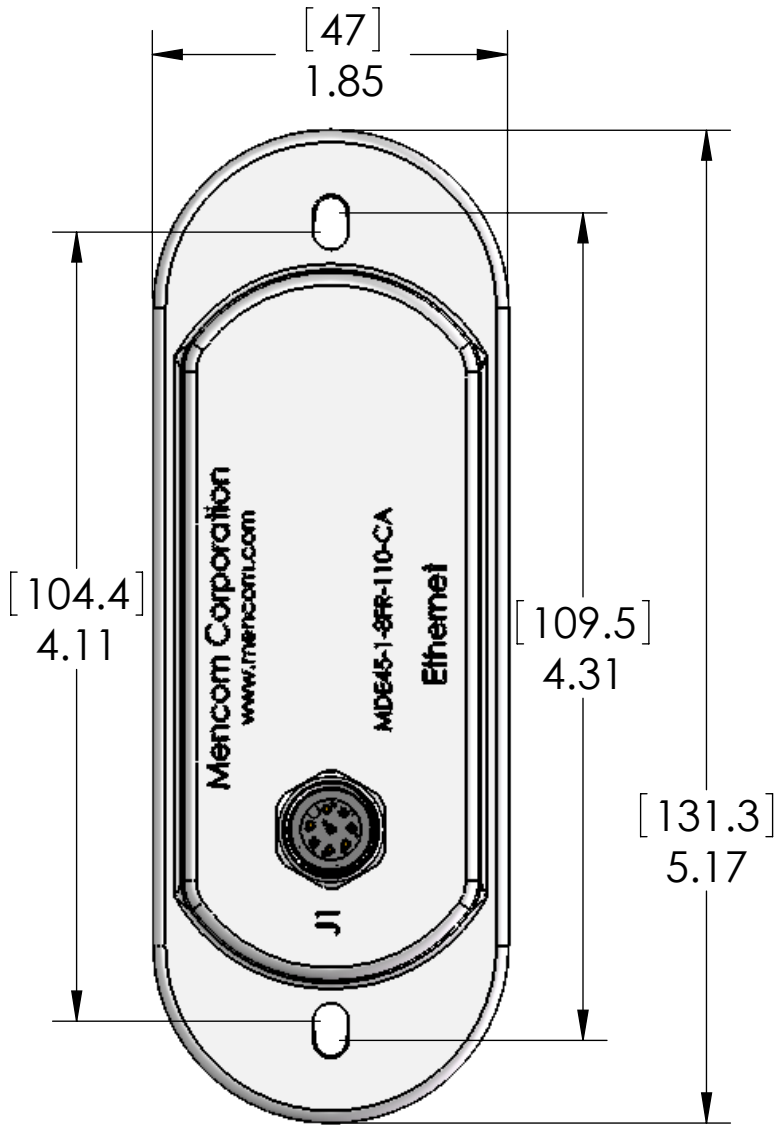

SEALING
GASKET

110 Punch Down Block
(cover is supplied
but now shown)

Included:

- 2 each 10-24 screws (for Form8 conduit bodies)
- 2 each 8-32 screws (for Mark 9 conduit bodies)

Can be mounted to 3/4" Form 8, Mark 9 and standard conduit bodies.

SPECIFICATIONS:	
HOUSING MATERIAL	GLASS FILLED PBT
RECEPTACLE HOUSING:	ANODIZED ALUMINUM
RECEPTACLE INSERT:	YELLOW PVC
RECEPTACLE CONTACTS:	GOLD PLATED COPPER ALLOY
OPERATING VOLTAGE:	40V
OPERATING CURRENT:	2A
OPERATING TEMPERATURE	-40°C - +70°C

PROPRIETARY AND CONFIDENTIAL
THE INFORMATION CONTAINED IN THIS DRAWING IS THE SOLE PROPERTY OF MENCOM CORPORATION. ANY REPRODUCTION IN PART OR AS A WHOLE WITHOUT THE WRITTEN PERMISSION OF MENCOM CORPORATION IS PROHIBITED.

		UNLESS OTHERWISE SPECIFIED: DIMENSIONS ARE IN INCHES AND [MM]		NAME	MENCOM CORPORATION					
			DRAWN	BEM					TITLE:	
			CHECKED							
			ENG APPR.							
			MFG APPR.							
		Q.A.								
		MATERIAL	COMMENTS:		SIZE DWG. NO. REV B MDE45-1-8FR-110-CA A					
		FINISH								
		DO NOT SCALE DRAWING			SCALE: 1:1		WEIGHT:		SHEET 1 OF 1	