

WIRING		
MALE		FEMALE
PIN #		PIN #
1	-----	1
2	-----	2
3	-----	3
4	-----	4
5	-----	5
6	-----	6
7	-----	7
8	-----	8
SHIELD TO COUPLING NUTS		

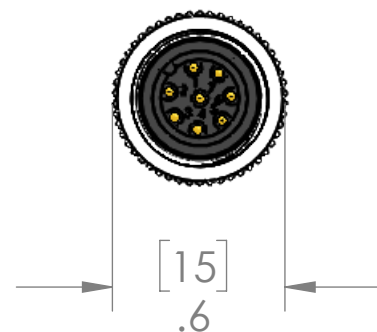

MATERIALS	
BODY:	YELLOW PUR
CONTACTS:	GOLD PLATED COPPER ALLOY
CABLE:	
STYLE:	AWM
AWG:	24 AWG
JACKET:	YELLOW PUR
VOLTAGE:	600V
SHIELD:	MYLAR W/DRAIN
COUPLING:	NICKEL PLATED BRASS
INSERT:	POLYAMIDE
O-RING:	FPM
APPROVALS	
US:	UL LISTED
CANADA:	C-UL LISTED
ROHS:	YES
CE & UKCA:	YES
RATINGS	
PROTECTION CLASS:	IEC IP69

PROPRIETARY AND CONFIDENTIAL

THE INFORMATION CONTAINED IN THIS
DRAWING IS THE SOLE PROPERTY OF
MENCOM CORPORATION. ANY
REPRODUCTION IN PART OR AS A WHOLE
WITHOUT THE WRITTEN PERMISSION OF
MENCOM CORPORATION IS
PROHIBITED.

VOLTS	60V
AMPS	2A
TEMP:	80°C

UNLESS OTHERWISE SPECIFIED: DIMENSIONS ARE IN INCHES AND [MM]	DRAWN BY	ADM
	DRAWN DATE	06/28/2023
	CHECKED BY	JJH
	CHECK DATE	06/29/2023
MATERIAL	COMMENTS:	
FINISH		
DO NOT SCALE DRAWING		

TABLE A		
P/N	L	STD?
MDCP-8MFPS-0.5M	20" [0.5M]	NO
MDCP-8MFPS-1M	40" [1M]	YES
MDCP-8MFPS-2M	79" [2M]	YES
MDCP-8MFPS-3M	118" [3M]	NO
MDCP-8MFPS-4M	157" [4M]	NO
MDCP-8MFPS-5M	197" [5M]	YES
MDCP-8MFPS-10M	393" [10M]	YES
MDCP-8MFPS-15M	591" [15M]	NO

PARTS LISTED AS NOT BEING STANDARD
MAY HAVE MINIMUM ORDER QUANTITIES

MENCOM CORPORATION			
TITLE: 8 POL MDC M-F EXT SHLD			
SIZE B	DWG. NO. MDCP-8MFPS-ZZ		REV B
SCALE: 3:2	WEIGHT:		SHEET 1 OF 1