

REVISIONS			
REV.	DESCRIPTION	DATE	APPROVED
A	Redrawn in SW	3/18/2009	
B	changed hex	5/18/2014	JJH

Recommended MAX Panel Thickness: 0.12" [3mm]
Recommended PCB thickness: 0.63" [1.6mm]

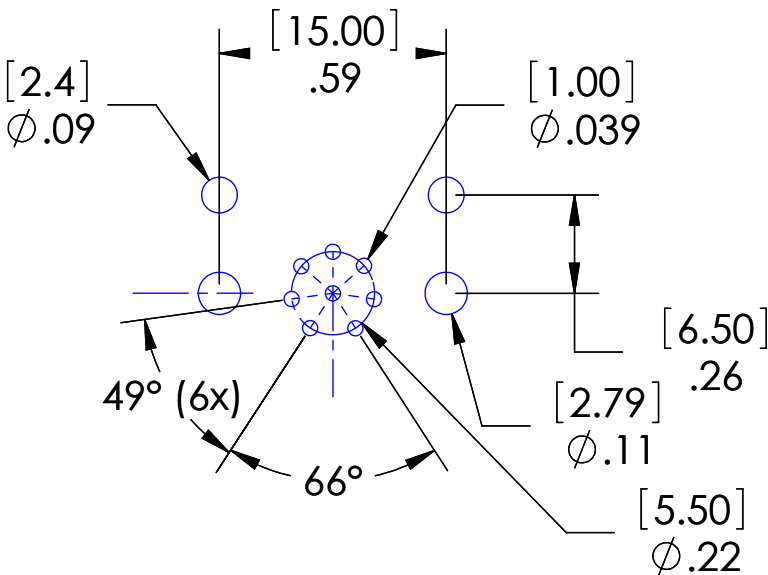
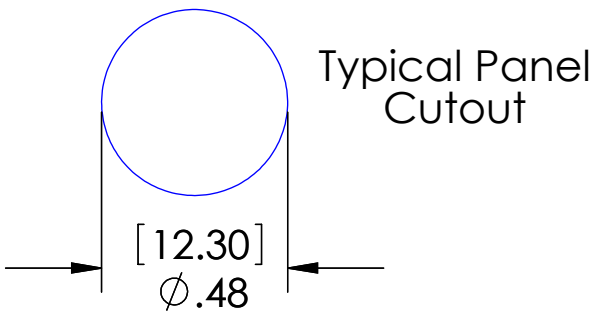
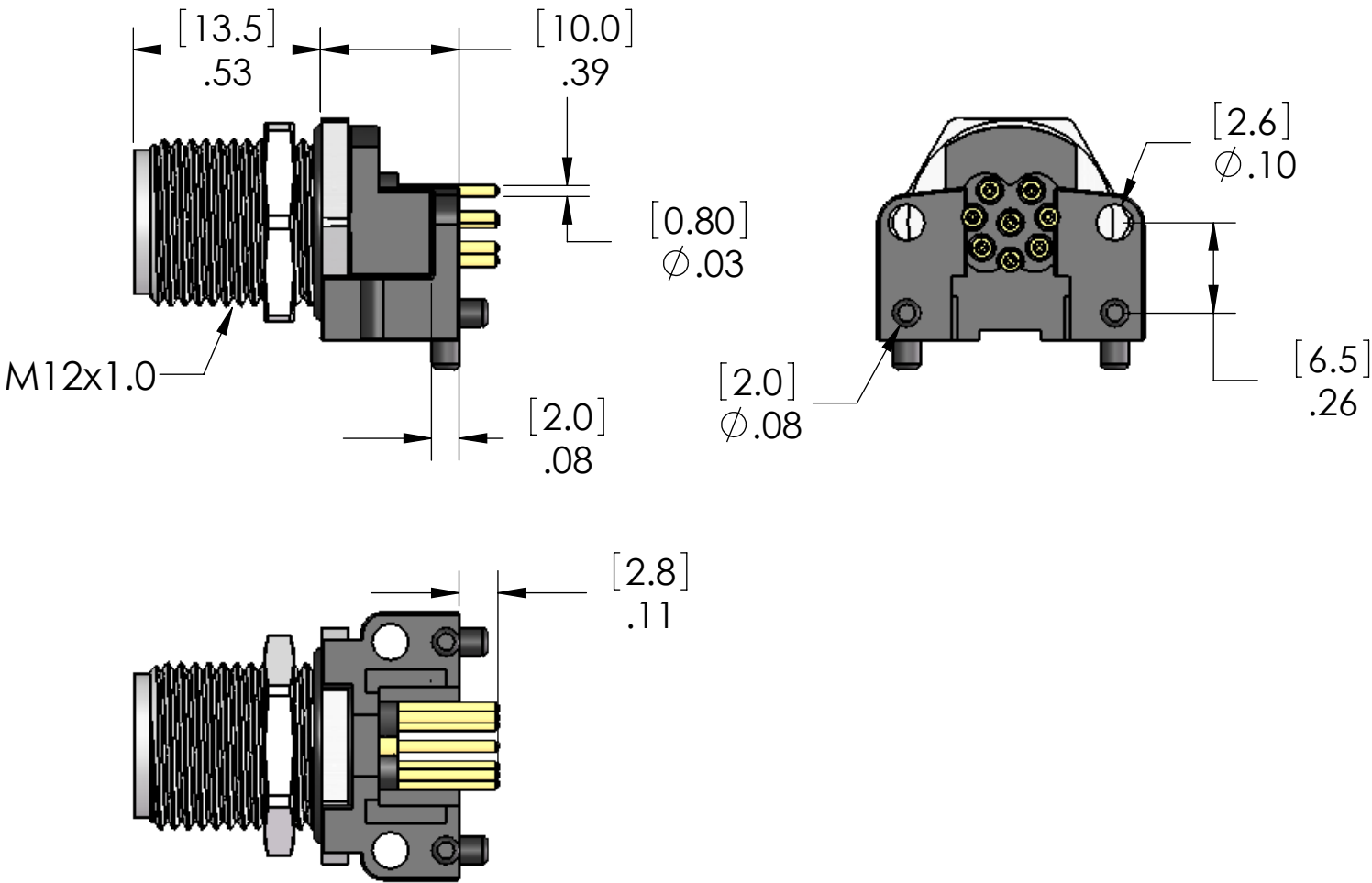

MATERIALS:	
BODY:	POLYAMIDE
METAL HDWR:	NICKEL PLATED BRASS
CONTACTS:	GOLD PLATED COPPER ALLOY
O-RING:	BUNA-N
RATINGS:	
VOLTAGE:	60V
AMPERAGE:	2A

PROPRIETARY AND CONFIDENTIAL
THE INFORMATION CONTAINED IN THIS DRAWING IS THE SOLE PROPERTY OF MENCOM CORPORATION. ANY REPRODUCTION IN PART OR AS A WHOLE WITHOUT THE WRITTEN PERMISSION OF MENCOM CORPORATION IS PROHIBITED.

UNLESS OTHERWISE SPECIFIED:		NAME	MENCOM CORPORATION	
DIMENSIONS ARE IN INCHES AND [MM]		DRAWN	BEM	TITLE:
		CHECKED		8 Pole Micro-DC pcb mt male (A - Coded)
		ENG APPR.		
		MFG APPR.		
		Q.A.		
MATERIAL		COMMENTS:		SIZE
FINISH				DWG. NO.
DO NOT SCALE DRAWING				REV
				B
				SCALE: 2:1
				WEIGHT:
				SHEET 1 OF 1