

REVISIONS			
REV.	DESCRIPTION	DATE	APPROVED
A	REDRAWN IN SW	3/19/2014	JJH

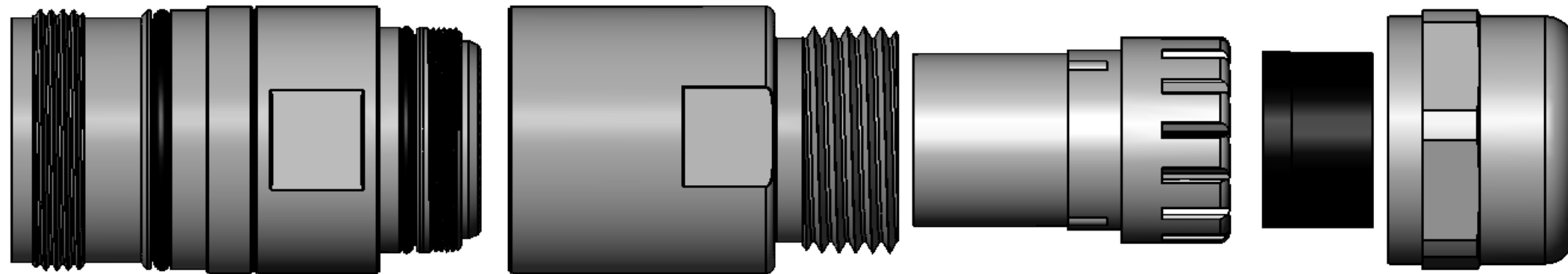
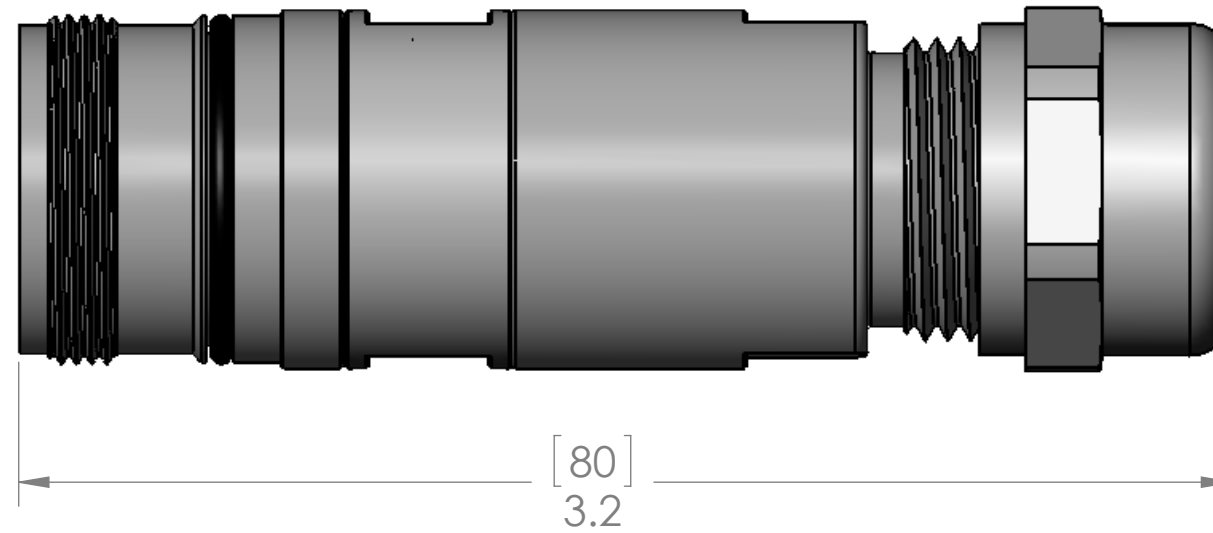
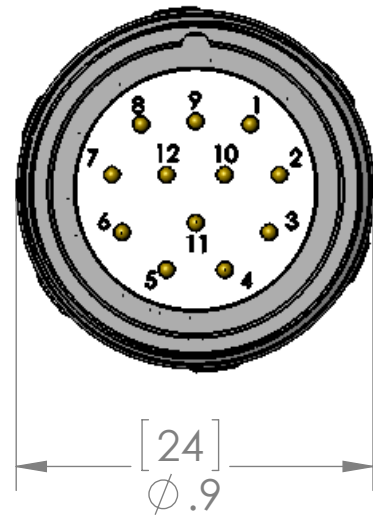

MATERIALS:	
BODY:	NICKEL PLATED BRASS
SEALS:	NBR
GLAND:	NICKEL PLATED BRASS
CONTACTS:	GOLD PLATED COPPER ALLOY
INSERT:	PBT & PPA
RATINGS:	
VOLTS:	150V
AMPS:	4A
TEMP:	-40°C (static) - +125°C
WIRE AWG:	18AWG - 24AWG
CABLE DIA.:	0.236 - 0.472" [6-12mm]

ALL CONNECTIONS MADE VIA SOLDER

PROPRIETARY AND CONFIDENTIAL

THE INFORMATION CONTAINED IN THIS DRAWING IS THE SOLE PROPERTY OF MENCOM CORPORATION. ANY REPRODUCTION IN PART OR AS A WHOLE WITHOUT THE WRITTEN PERMISSION OF MENCOM CORPORATION IS PROHIBITED.

		UNLESS OTHERWISE SPECIFIED:		NAME	MENCOM CORPORATION			
		DIMENSIONS ARE IN INCHES AND [MM]	DRAWN	BEM				TITLE:
			CHECKED					
			ENG APPR.					
			MFG APPR.					
			Q.A.		12 PL ML FW SLDR CUP			
			COMMENTS:					
		MATERIAL			SIZE	DWG. NO.	REV	
		FINISH			B	MCV-12MPM-FW	A	
		DO NOT SCALE DRAWING			SCALE: 2:1	WEIGHT:	SHEET 1 OF 1	