

REVISIONS			
REV.	DESCRIPTION	DATE	APPROVED
A	REDRAWN IN SW	6/23/2010	BEM

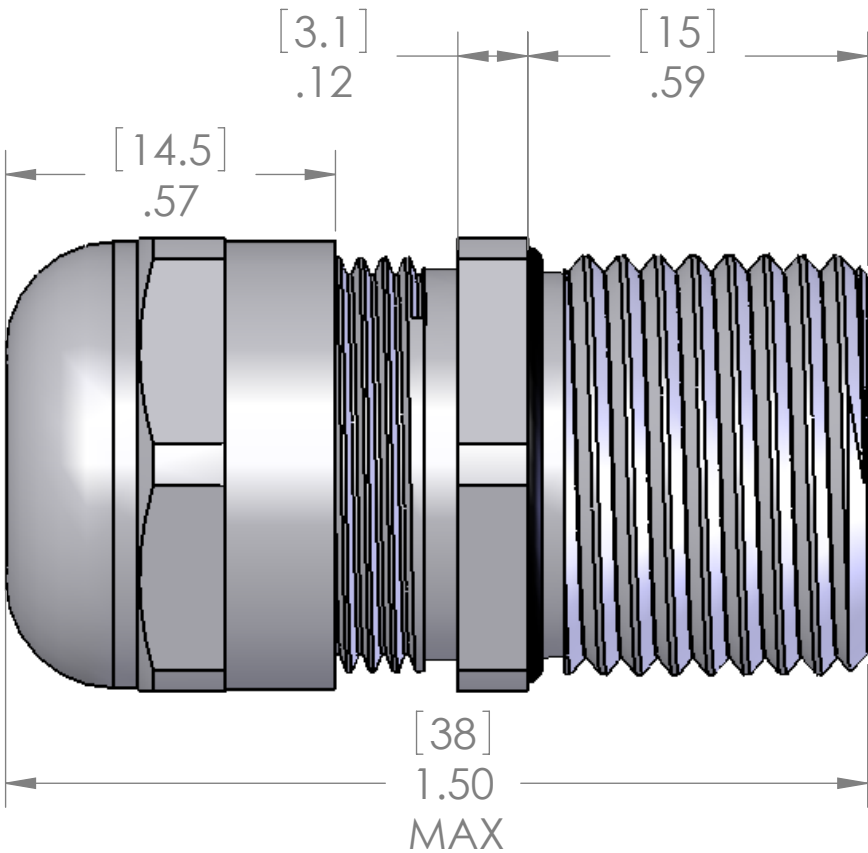
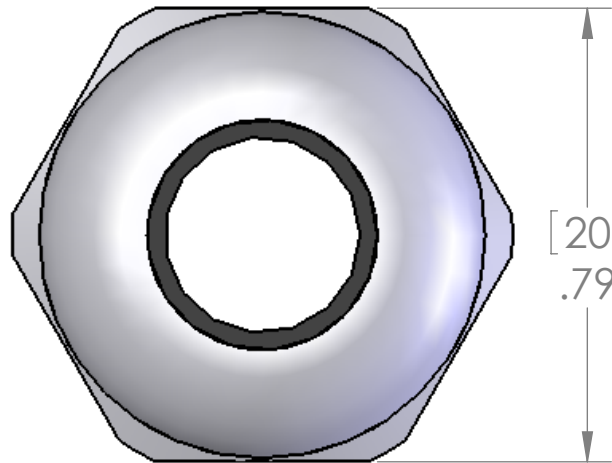

PG11 THREAD

LOCK NUT INCLUDED BUT NOT SHOWN

SEAL RATED TO: IP68

SPECIFICATIONS:	
TIGHTENING TORQUE:	6.25 Nm
TEMPERATURE:	-20°C - +100°C
MATERIALS:	
BODY:	NICKEL PLATED BRASS
INSERT:	POLYAMIDE
GROMMET:	NEOPRENE
LOCK NUT:	NICKEL PLATED BRASS
O-RING:	BUNA-N

PART NUMBER	SEALING RANGE
MCG-11L	.197 - .393 [5 - 10 mm]

PROPRIETARY AND CONFIDENTIAL
THE INFORMATION CONTAINED IN THIS DRAWING IS THE SOLE PROPERTY OF MENCOM CORPORATION. ANY REPRODUCTION IN PART OR AS A WHOLE WITHOUT THE WRITTEN PERMISSION OF MENCOM CORPORATION IS PROHIBITED.

UNLESS OTHERWISE SPECIFIED:		NAME	MENCOM CORPORATION	
DIMENSIONS ARE IN INCHES & [MM]		DRAWN	BEM	TITLE:
		CHECKED		
		ENG APPR.		
		MFG APPR.		
MATERIAL		Q.A.		SIZE
		COMMENTS:		
FINISH				DWG. NO.
DO NOT SCALE DRAWING				MCG-11L
				REV
				A
		SCALE: 3:1	WEIGHT:	SHEET 1 OF 1