

PANEL CUTOUT

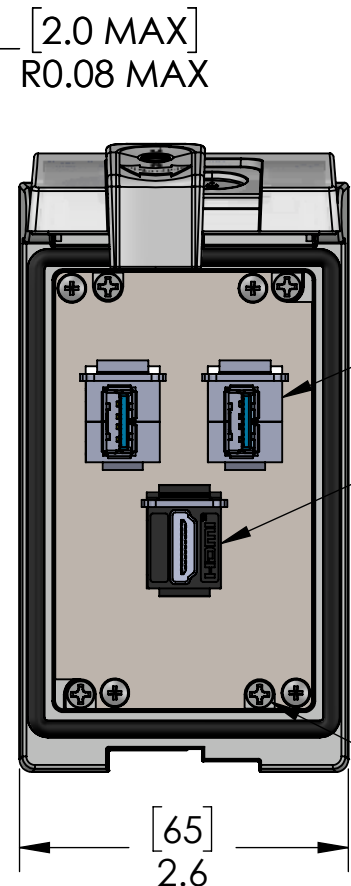
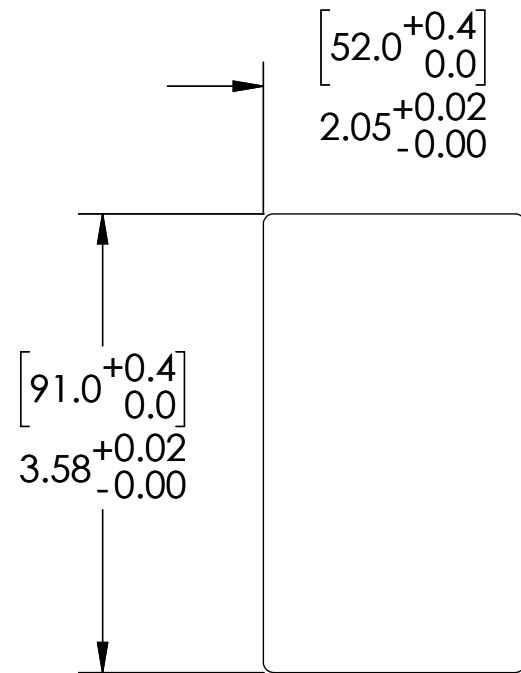

— [2.0 MAX]
R0.08 MAX

— (2X)USB 3.0 TYPE A CONFIGURED
FEMALE EXTERIOR / FEMALE INTERIOR

—HDMI CONFIGURED FEMALE (EXTERIOR)
TO TYPE A FEMALE (INTERIOR)

— (X4) USE PH2 SCREW DRIVER ON MOUNTING SCREWS. (REF. MOUNTING SCREW TORQUE)

ROTATE TWO TURNS COUNTER
CLOCKWISE TO RELEASE THE
TURN BUCKLE PRIOR TO TIGHTENING

TURN BUCKLES ROTATE 90 DEG. INTO
THEIR CLAMPING POSITION AS
MOUNTING SCREWS TIGHTEN.
DO NOT OVER-TORQUE!_____

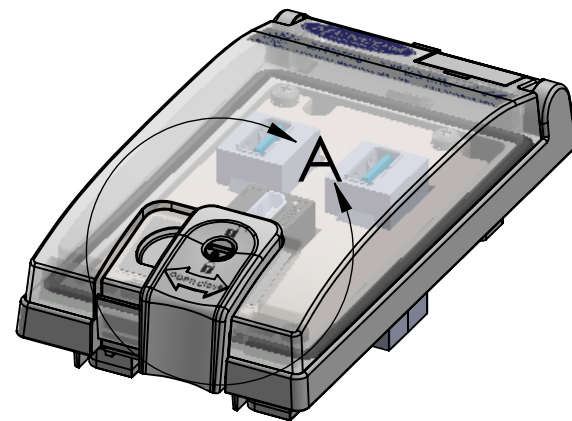

SLIDE LATCH TO OPEN/CLOSE
ROTATE LOCK TO LOCK CLOSED

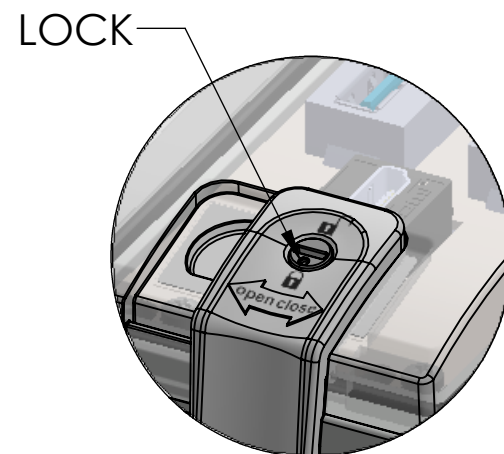

DETAIL A
SCALE 1 : 1

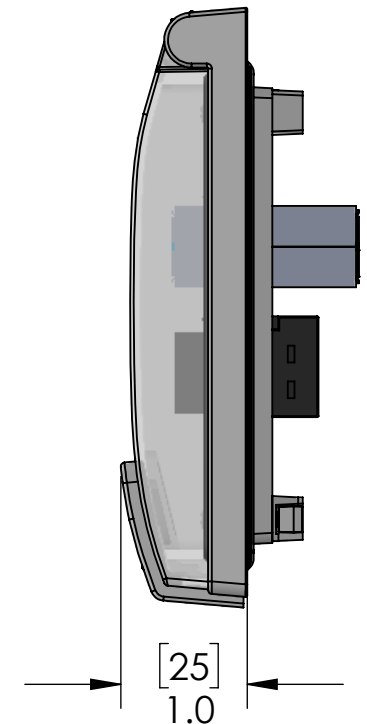
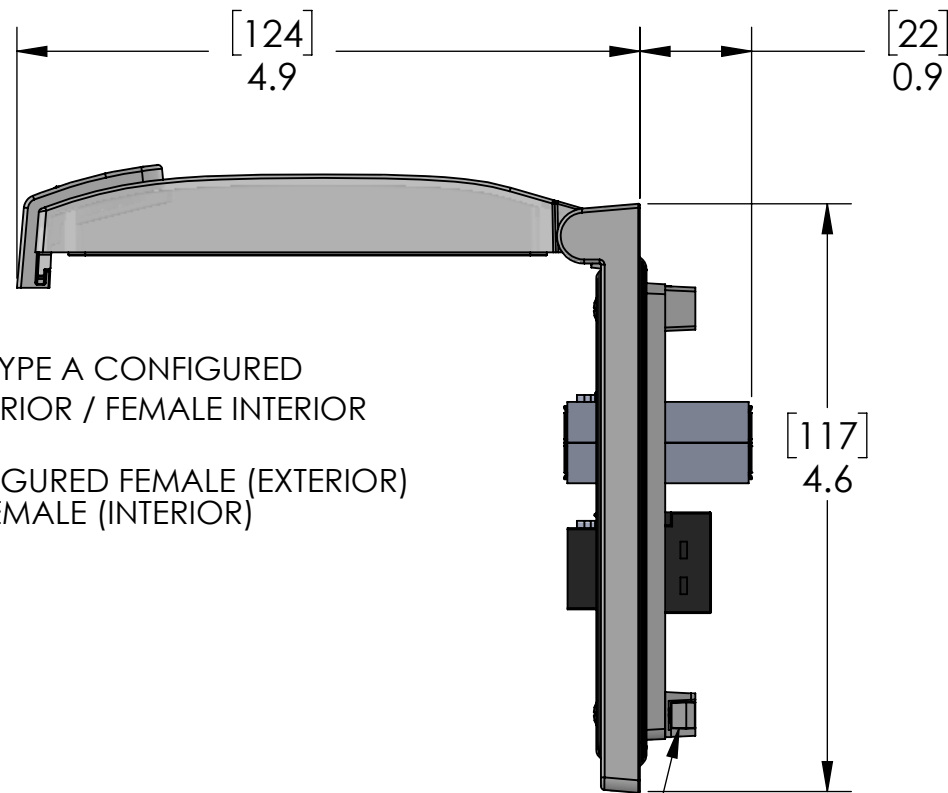

These devices shall be mounted on enclosures having adequate strength and thickness and with adequate spacing provided. Seal rating is based on mounting to a surface that is clean, flat and smooth.

US		PIC RATINGS/SPECIFICATIONS	
NEMA/UL EN 60529:		4, 12 IP65	
PANEL THICKNESS:		5.0mm max	
MOUNTING SCREW TORQUE:		0.8N-m	
D:	DRAWN BY	DCG	MENCOM CORPORATION TITLE: HDMI; 2 X USB-AA; LP1
	DRAWN DATE	08/27/2021	
	CHECKED BY	DCG	
	CHECK DATE	08/27/2021	
	COMMENTS:		
	SIZE	DWG. NO.	REV
	B	LP1-HDMI-2USB-AFAF	C
	SCALE: 2:3	WEIGHT:	SHEET 1 OF 1

PROPRIETARY AND CONFIDENTIAL

THE INFORMATION CONTAINED IN THIS
DRAWING IS THE SOLE PROPERTY OF
MENCOM CORPORATION. ANY
REPRODUCTION IN PART OR AS A WHOLE
WITHOUT THE WRITTEN PERMISSION OF
MENCOM CORPORATION IS
PROHIBITED.

			UNLESS OTHERWISE SPECIFIED
HOUSING MATERIALS			DIMENSIONS ARE IN INCHES AND [MM]
BODY:	NICKEL PLATED ZINC		
GASKETS:	PUR FIPG		
FRONT COVER:	POLYCARBONATE		
LATCH & LOCK:		PBT	
IDENTICAL IDENTICAL IN THIS PROPERTY OF ANY AS A WHOLE IDENTICAL OF			
			MATERIAL
			FINISH
			DO NOT SCALE DRAWING