

PANEL CUTOUT

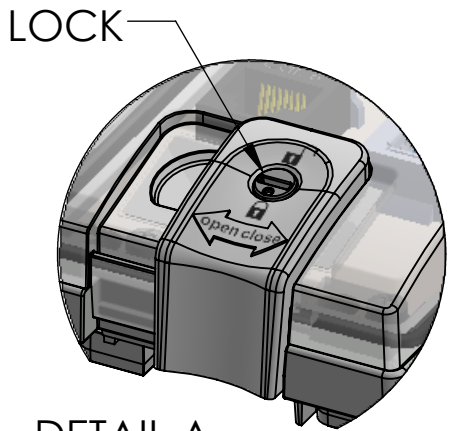
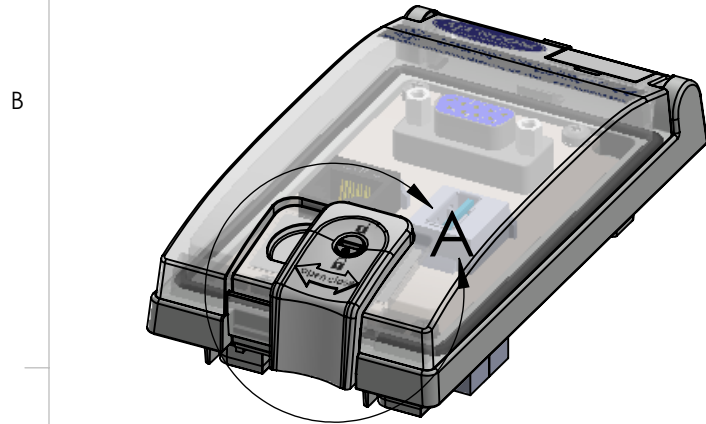
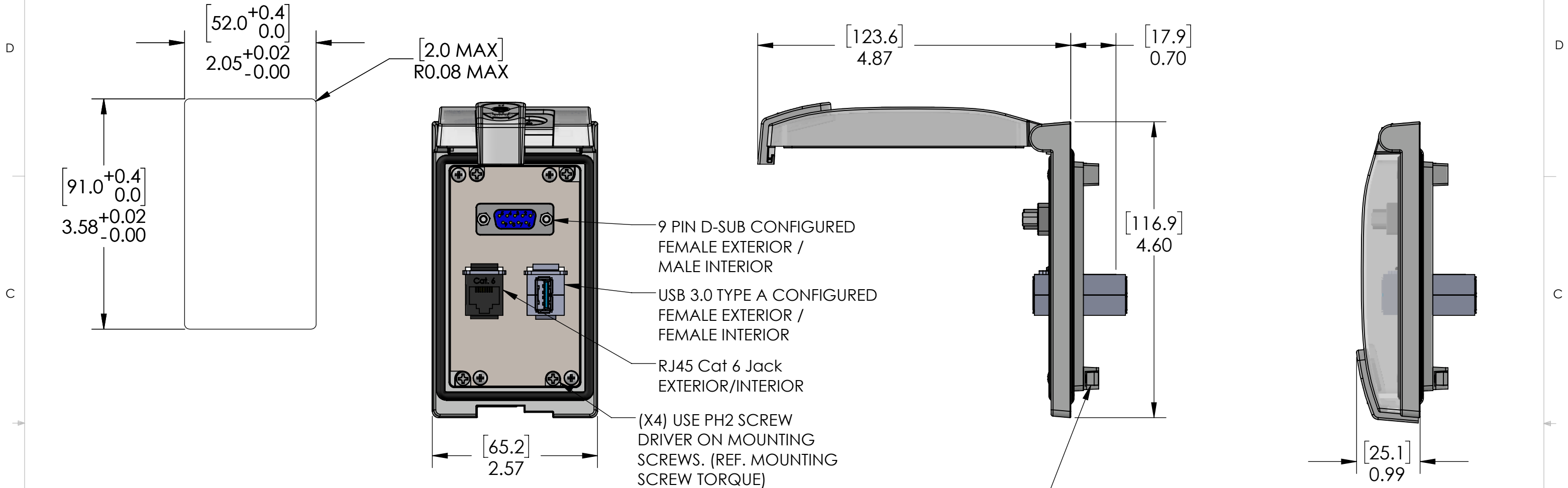

DETAIL A
SCALE 1 : 1

SLIDE LATCH TO OPEN/CLOSE
ROTATE LOCK TO LOCK CLOSED

ROTATE TWO TURNS COUNTER
CLOCKWISE TO RELEASE THE
TURN BUCKLE PRIOR TO TIGHTENING

TURN BUCKLES ROTATE 90 DEG. INTO
THEIR CLAMPING POSITION AS
MOUNTING SCREWS TIGHTEN.
DO NOT OVER-TORQUE!

These devices shall be mounted on enclosures having adequate strength and thickness and with adequate spacing provided. Seal rating is based on mounting to a surface that is clean, flat and smooth.



OPERATING TEMPERATURE: (-10°C / +60° C (+14° F / +140° F))

HOUSING MATERIALS	
BODY:	NICKEL PLATED ZINC
GASKETS:	PUR FIPG
FRONT COVER:	POLYCARBONATE
LATCH & LOCK:	PBT

UNLESS OTHERWISE SPECIFIED:
DIMENSIONS ARE IN INCHES
TOLERANCES:
FRACTIONAL ±1/64
ANGULAR: MACH ±5° BEND ±5°
TWO PLACE DECIMAL ±.01
THREE PLACE DECIMAL ±.004

PIC RATINGS/SPECIFICATIONS			
NEMA/UL EN 60529:	4, 12	IP65	
PANEL THICKNESS:	5.0mm	max	
MOUNTING SCREW TORQUE:	0.8N-m		
MENCOM CORPORATION			
TITLE: DB9; RJ45; USB-AA; LP1			
SIZE B	DWG. NO. LP1-DB9-RJ45-USB-AFAF	REV A	
SCALE: 2:3	WEIGHT:	SHEET 1 OF 1	

PROPRIETARY AND CONFIDENTIAL
THE INFORMATION CONTAINED IN THIS
DRAWING IS THE SOLE PROPERTY OF
MENCOM CORPORATION. ANY
REPRODUCTION IN PART OR AS A WHOLE
WITHOUT THE WRITTEN PERMISSION OF
MENCOM CORPORATION IS
PROHIBITED.

MATERIAL
FINISH
DO NOT SCALE DRAWING