

PANEL CUTOUT

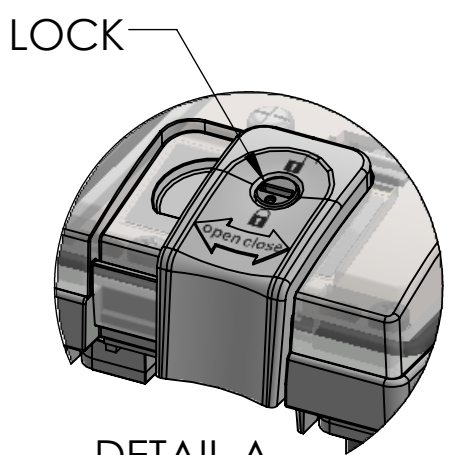
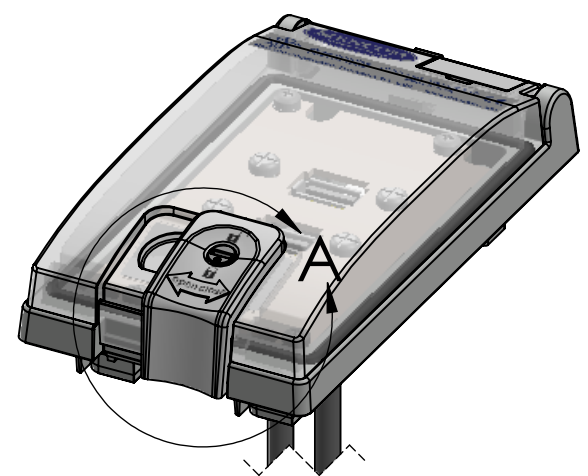
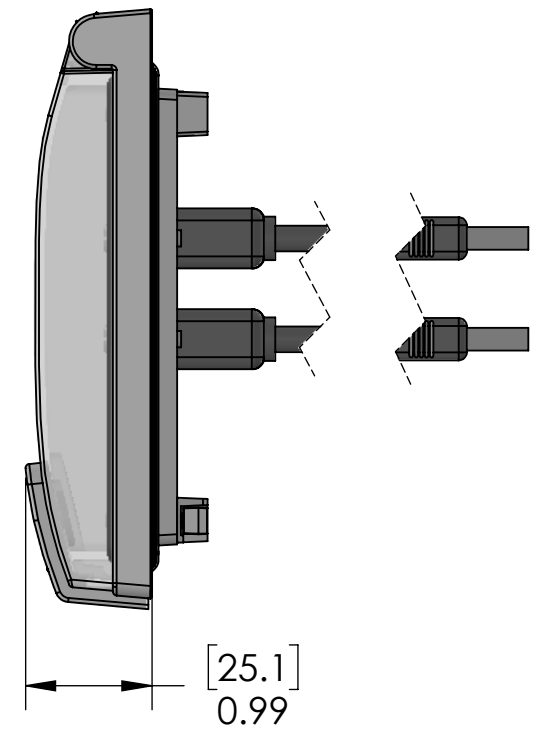
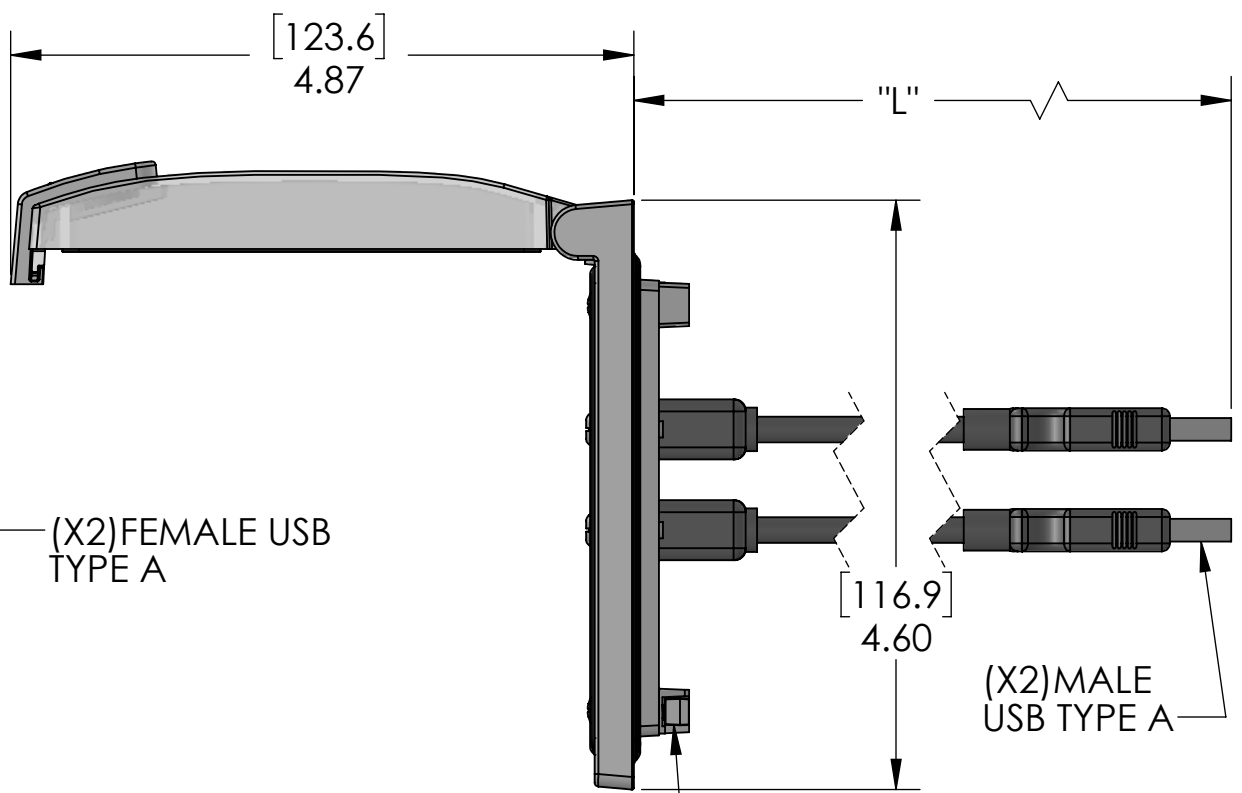
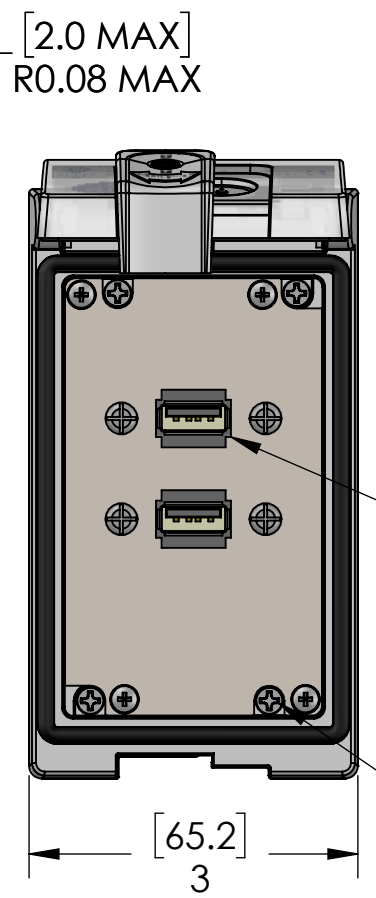
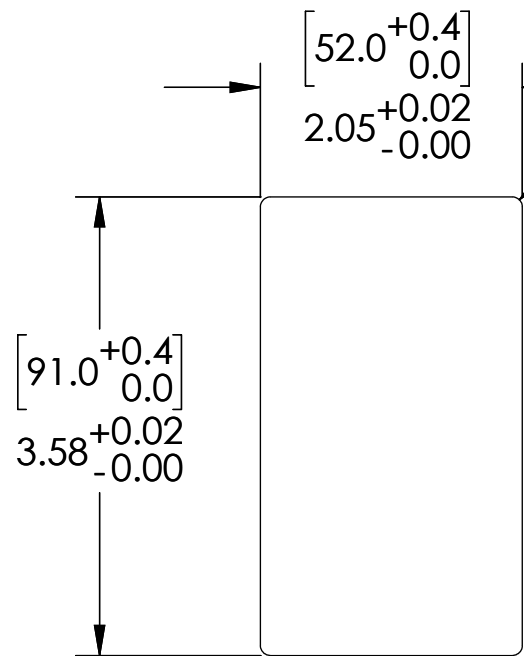

SLIDE LATCH TO OPEN/CLOSE  
ROTATE LOCK TO LOCK CLOSED

DETAIL A  
SCALE 1 : 1

(X2) FEMALE USB  
TYPE A

(X4) USE PH2 SCREW  
DRIVER ON MOUNTING  
SCREWS. (REF. MOUNTING  
SCREW TORQUE)

ROTATE TWO TURNS COUNTER  
CLOCKWISE TO RELEASE THE  
TURN BUCKLE PRIOR TO TIGHTENING

TURN BUCKLES ROTATE 90 DEG. INTO  
THEIR CLAMPING POSITION AS  
MOUNTING SCREWS TIGHTEN.  
DO NOT OVER-TORQUE!

(X2) MALE  
USB TYPE A

PART NUMBER	LENGTH "L"
LP1-2USB-03	3 FEET
LP1-2USB-06	6 FEET
LP1-2USB-10	10 FEET

These devices shall be mounted on enclosures having adequate strength and thickness and with adequate spacing provided. Seal rating is based on mounting to a surface that is clean, flat and smooth.



PIC RATINGS/SPECIFICATIONS

NEMA/UL   EN 60529:	4, 12   IP65
PANEL THICKNESS:	5.0mm max
MOUNTING SCREW TORQUE:	0.8N-m

OPERATING TEMPERATURE: (-10°C / +80° C (+14° F / +176° F))

HOUSING MATERIALS		UNLESS OTHERWISE SPECIFIED:
BODY:	NICKEL PLATED ZINC	DIMENSIONS ARE IN INCHES AND [MM]
GASKETS:	PUR FIPG	
FRONT COVER:	POLYCARBONATE	
LATCH & LOCK:	PBT	

**PROPRIETARY AND CONFIDENTIAL**  
THE INFORMATION CONTAINED IN THIS DRAWING IS THE SOLE PROPERTY OF MENCOM CORPORATION. ANY REPRODUCTION IN PART OR AS A WHOLE WITHOUT THE WRITTEN PERMISSION OF MENCOM CORPORATION IS PROHIBITED.

MATERIAL		DRAWN BY		MENCORPORATION	
		DG		TITLE:	
		DRAWN DATE	12/06/2016	2 USB ZZ; LP1	
		CHECKED BY		SIZE DWG. NO.	
		CHECK DATE		B LP1-2USB-ZZ	
		COMMENTS:		REV	
				A	
				SCALE: 2:3	WEIGHT:
				SHEET 1 OF 1	

DO NOT SCALE DRAWING