

D

C

B

A

D

C

B

A

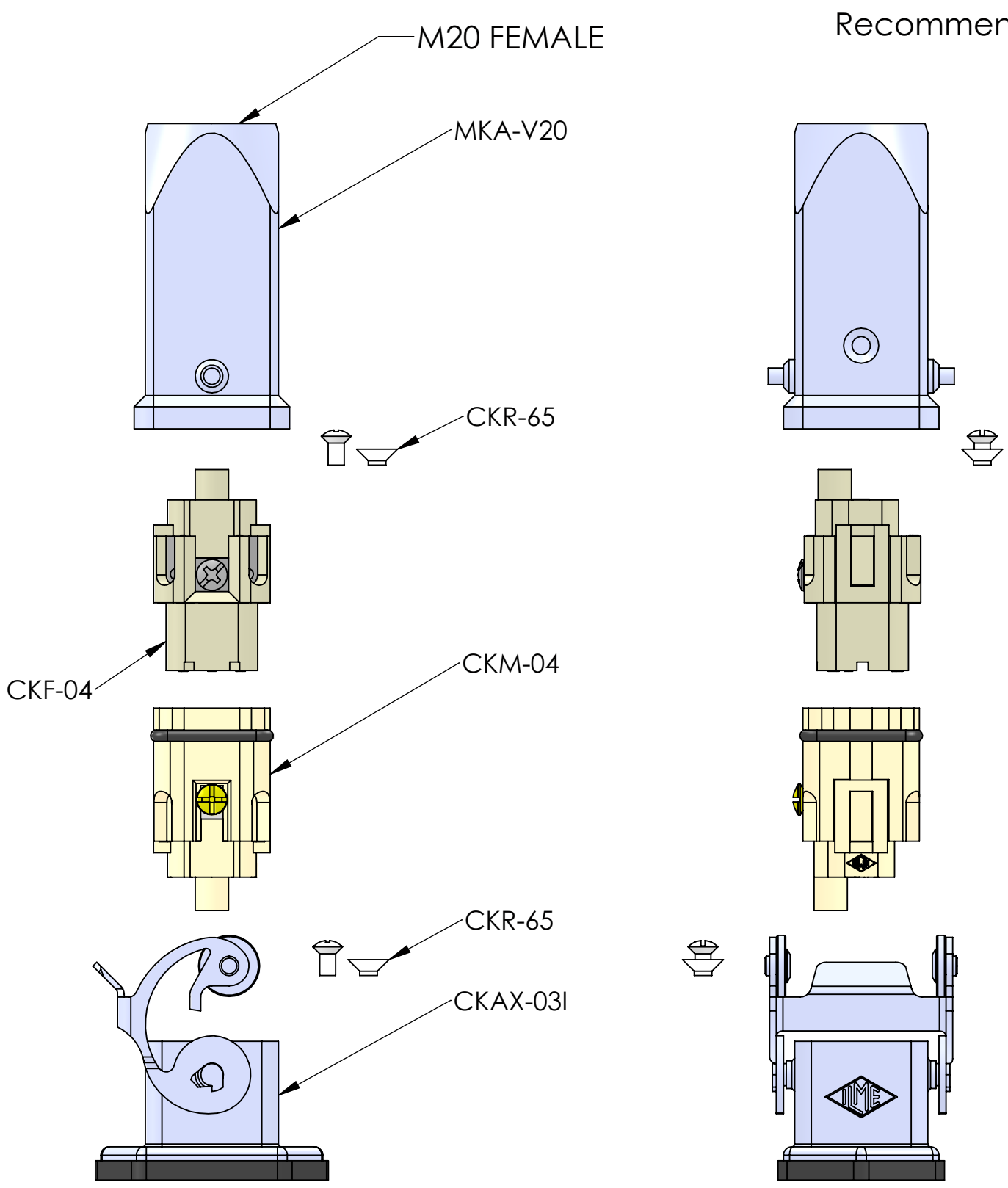

Recommended cable gland for M20 opening (ordered separately):  
Plastic (gray polyamide): PCGU-M20 (for 5 - 13mm dia. cables)  
Metal (Nickel Plated Brass): MCG-M20 (for 9 - 13mm dia. cables)

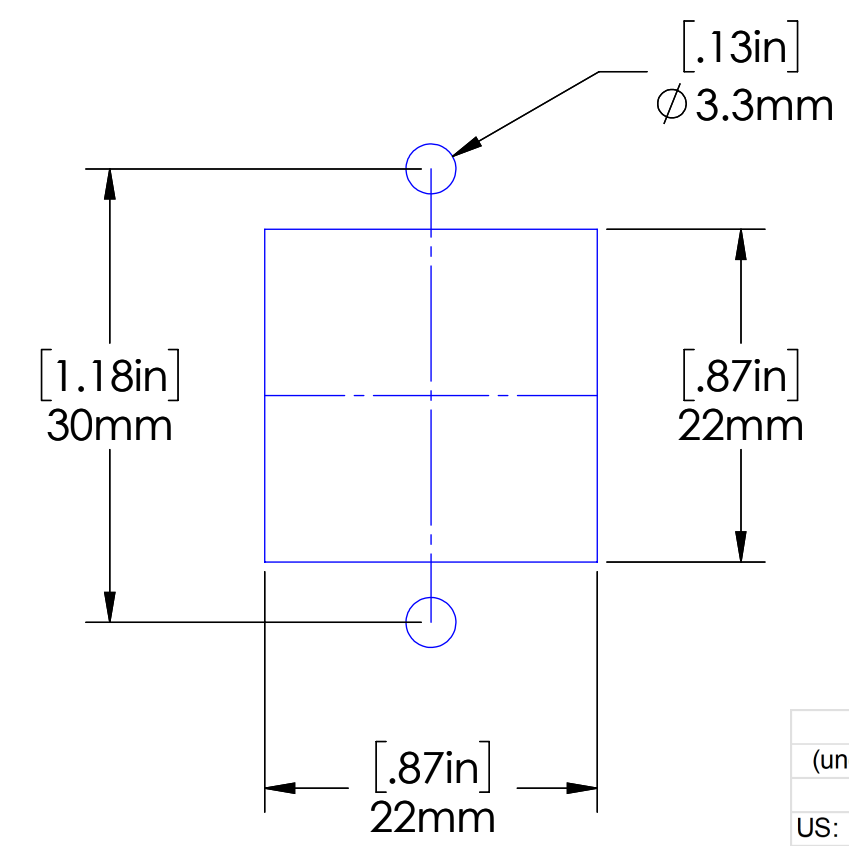

PANEL CUTOUT

Certifications	
(under individual component part numbers)	
US:	UL Recognized
Canada:	C-UL Recognized
Europe:	CE
China:	CCC

MATERIALS				
BODY:		EPOXY COATED DIE CAST ALUMINUM		
GASKET:		THERMOPLASTIC ELASTOMER		
HANDLE:		POLYAMIDE		
LEVERS:		STAINLESS STEEL		
INSERTS:		GLASS REINFORCED THERMOPLASTIC		
CONTACTS:		SILVER PLATED COPPER ALLOY		
DRAWN BY	DCG	MENCOM CORPORATION  TITLE:  CK 4 PL ILME KIT		
DRAWN DATE	10/31/2024			
CHECKED BY	ADM			
CHECK DATE	10/31/2024			
COMMENTS:		SIZE	DWG. NO.	REV
		B	KMNLS-04IV20	A
		SCALE: 2:1	WEIGHT:	SHEET 1 OF 1

Environmental Ratings:	
NEMA / UL:	4, 4X, 12
UNLESS OTHERWISE SPECIFIED:	
DIMENSIONS ARE IN INCHES AND [MM]	
MATERIAL	
FINISH	
DO NOT SCALE DRAWING	

**PROPRIETARY AND CONFIDENTIAL**  
THE INFORMATION CONTAINED IN THIS DRAWING IS THE SOLE PROPERTY OF MENCOM CORPORATION. ANY REPRODUCTION IN PART OR AS A WHOLE WITHOUT THE WRITTEN PERMISSION OF MENCOM CORPORATION IS PROHIBITED.

The Enclosures ensure IP66/67/69 protection rating with CKR-65 when mated and locked with the closing levers.