

PANEL CUTOUT

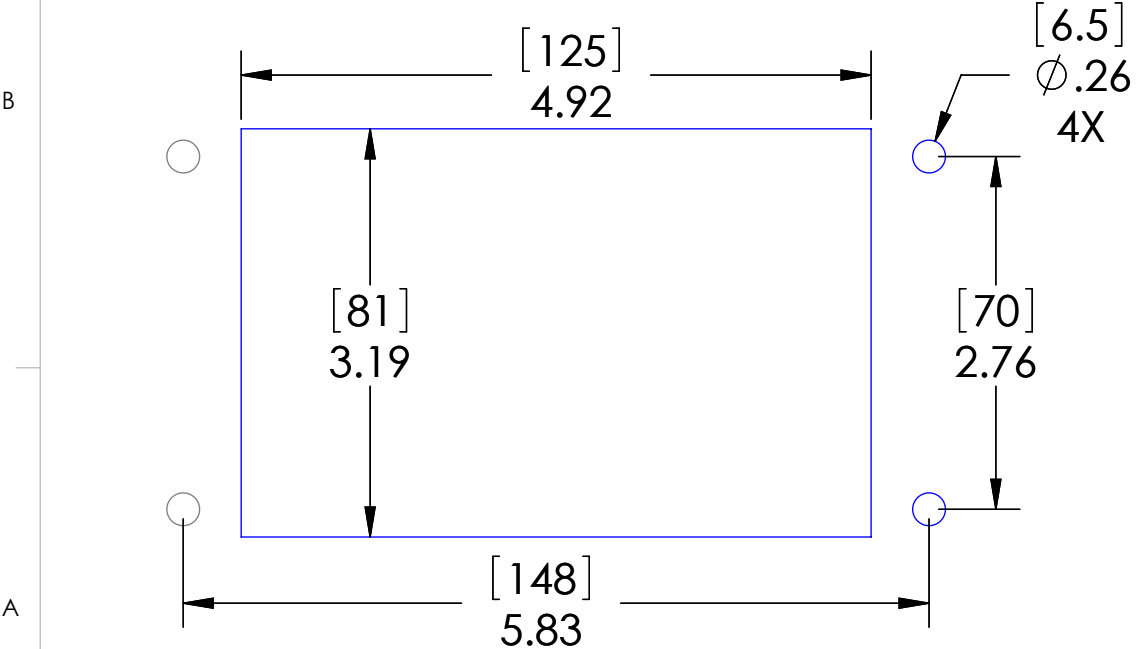

STANDARD CONFIGURATIONS UNLESS OTHERWISE NOTED		
CONN. TYPE	EXTERIOR	INTERIOR
RJ45	CAT 6 JACK	CAT 6 JACK
HDMI	FEMALE	FEMALE

OPERATING TEMPERATURE: (-10°C / +60° C (+14° F / +140° F))

MOUNTING KIT ORDERED SEPARATELY CONTAINS M6x1 SS SCREW, NYLON WASHER, SPLIT LOCKWASHER AND M6 NUT
P/N: D-PIC48-MT

HOUSING MATERIALS	
BODY:	EPOXY COATED DIE CAST ALUMINUM
GASKET:	THERMOPLASTIC ELASTOMER
HANDLE:	STAINLESS STEEL



UNLESS OTHERWISE SPECIFIED:
DIMENSIONS ARE IN INCHES AND [MM]

PROPRIETARY AND CONFIDENTIAL		
THE INFORMATION CONTAINED IN THIS DRAWING IS THE SOLE PROPERTY OF MENCOM CORPORATION. ANY REPRODUCTION IN PART OR AS A WHOLE WITHOUT THE WRITTEN PERMISSION OF MENCOM CORPORATION IS PROHIBITED.		
	MATERIAL	
	FINISH	
	DO NOT SCALE DRAWING	

These devices shall be mounted on enclosures having adequate strength and thickness and with adequate spacing provided. Seal rating is based on mounting to a surface that is clean, flat and smooth.

PIC RATINGS/SPECIFICATIONS	
VOLTS:	125V
AMPS:	3A
SCCR:	0.2kA
NEMA/UL EN 60529:	4, 4X, 12 IP65
MOUNTING SCREW SIZE:	M6 (1/4-20) (304 or 316SS for 4X)
MOUNTING SCREW TORQUE:	3.0~3.6N-m (2.2~2.7 Lb-Ft)
INCOMING POWER WIRE SIZE:	0.5 ~ 4.0 sq mm / 20-12AWG
WIRE STRIP LENGTH:	10 ~ 11 mm

DRAWN BY	DCG
DRAWN DATE	07/08/2021
CHECKED BY	DCG
CHECK DATE	07/08/2021

COMMENTS:

MENCOM CORPORATION		
TITLE:		
GFI; HDMI; RJ45; USB-AA; 3A; 48		
SIZE	DWG. NO.	REV
B	GF-HDMI-RJ45-USB-AFAF-R-48	C
SCALE: 2:3	WEIGHT:	SHEET 1 OF 1