

PANEL CUTOUT

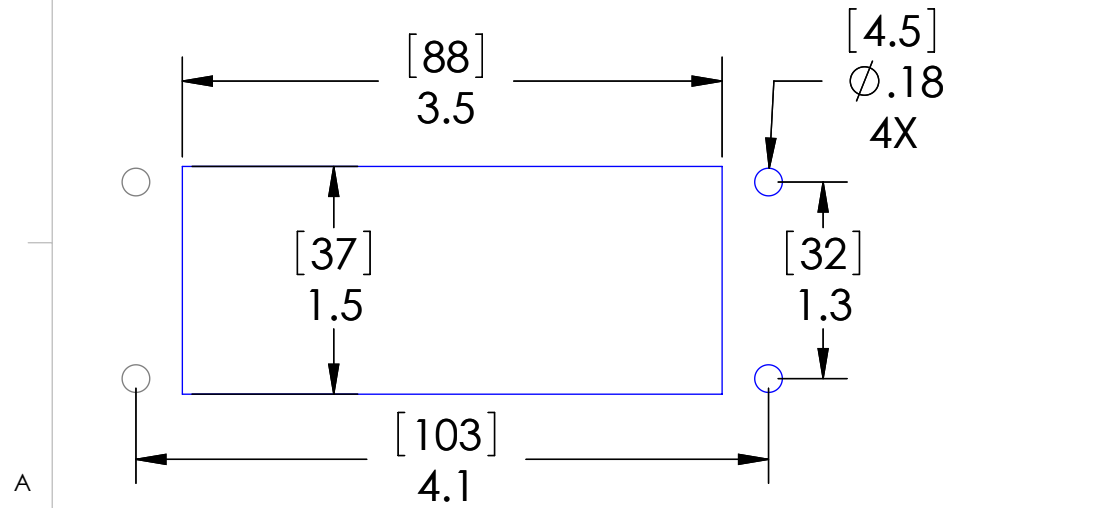

STANDARD CONFIGURATIONS UNLESS OTHERWISE NOTED		
CONN. TYPE	EXTERIOR	INTERIOR
RJ45	CAT 6 JACK	CAT 6 JACK
ALL D-SUBS	FEMALE	MALE

For power connector, crimp terminals are supplied for hot, neutral and ground connections.

These devices shall be mounted on enclosures having adequate strength and thickness and with adequate spacing provided. Seal rating is based on mounting to a surface that is clean, flat and smooth.

HOUSING MATERIALS		PIC RATINGS/SPECIFICATIONS	
BODY:	EPOXY COATED DIE CAST ALUMINUM	VOLTS:	125V
GASKET:	THERMOPLASTIC ELASTOMER	AMPS:	3A
HANDLE:	POLYAMIDE	SCCR:	0.2kA
LEVERS:	STAINLESS STEEL	NEMA/UL EN 60529:	4, 4X, 12 IP65
OPERATING TEMPERATURE: (-10°C / +60° C (+14° F / +140° F))		MOUNTING SCREW SIZE:	M4 (8-32) (304 or 316SS for 4X)
MOUNTING KIT ORDERED SEPARATELY CONTAINS M4x0.7 SS SCREW, NYLON WASHER, SPLIT LOCKWASHER AND M4 NUT		MOUNTING SCREW TORQUE:	1.2~1.8N-m (0.9~1.3 Lb-Ft)
P/N: D-PIC-MT		INCOMING POWER WIRE SIZE:	0.5 ~ 4.0 sq mm / 20-12AWG
UNLESS OTHERWISE SPECIFIED:		WIRE STRIP LENGTH:	10 ~ 11 mm
DIMENSIONS ARE IN INCHES AND [MM]		DRAWN BY	DCG
MATERIAL		DRAWN DATE	07/13/2021
FINISH		CHECKED BY	DCG
DO NOT SCALE DRAWING		CHECK DATE	07/15/2021
COMMENTS:		MENCOM CORPORATION	
TITLE:		SMPLX; DB9: RJ45; 16	
SIZE		DWG. NO.	REV
B		DP1-DB9-RJ45-R-16	C
SCALE: 13:16		WEIGHT:	SHEET 1 OF 1