

TS SYSTEM ALLOWS UNIT TO BE SNAP FASTENED ONTO
DIN EN 50022 RAIL.

OR

MOUNTING HOLES IN BOTTOM OF UNIT ALLOW FOR
MOUNTING INSIDE OF PANELS WITH FIXED FASTENERS

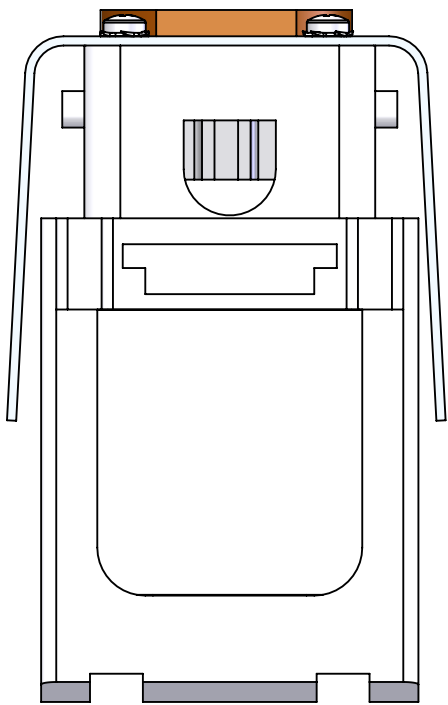

For power connector, crimp terminals
are supplied for hot, neutral and
ground connections.

HOUSING MATERIAL		VOLTS:		125V	
PLATE:	304 STAINLESS	AMPS:		20A	
BODY:	SELF-EXTINGUISHING THERMOPLASTIC	SCCR:		10kA	
OPERATING TEMPERATURE: (-40°C / +60° C (-40° F / +140° F))		MOUNTING SCREW SIZE:		M4 (8-32)	
		INCOMING POWER WIRE SIZE:		14-16AWG	
		UNLESS OTHERWISE SPECIFIED:		MENCOM CORPORATION	
		DIMENSIONS ARE IN INCHES AND [MM]			
		DRAWN BY DCG			
		DRAWN DATE 08/16/2021			
		CHECKED BY DCG			
		CHECK DATE 08/16/2021		TITLE: DINRAIL;DUPLX	
		COMMENTS:		SIZE DWG. NO. REV B DP-TS20 C	
		DO NOT SCALE DRAWING		SCALE: 1:1 WEIGHT: SHEET 1 OF 1	

PROPRIETARY AND CONFIDENTIAL
THE INFORMATION CONTAINED IN THIS
DRAWING IS THE SOLE PROPERTY OF
MENCOM CORPORATION. ANY
REPRODUCTION IN PART OR AS A WHOLE
WITHOUT THE WRITTEN PERMISSION OF
MENCOM CORPORATION IS
PROHIBITED.

UNLESS OTHERWISE SPECIFIED:
DIMENSIONS ARE IN INCHES
AND [MM]

MATERIAL

FINISH

DO NOT SCALE DRAWING

TITLE:

DINRAIL;DUPLX

REV
C