

TS SYSTEM ALLOWS UNIT TO BE SNAP FASTENED ONTO DIN EN 50022 RAIL.

OR

MOUNTING HOLES IN BOTTOM OF UNIT ALLOW FOR MOUNTING INSIDE OF PANELS WITH FIXED FASTENERS

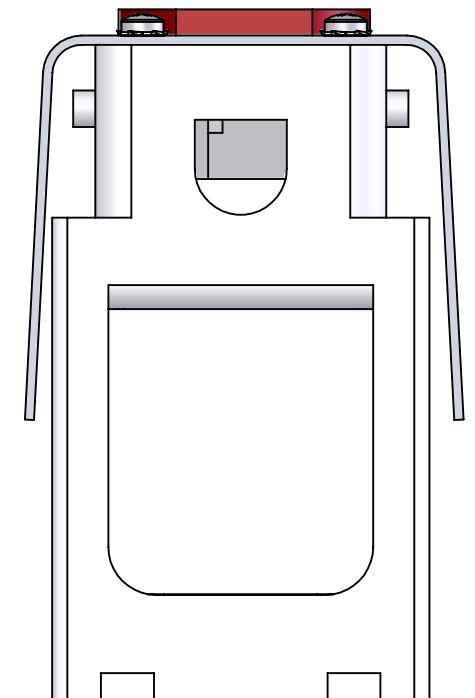
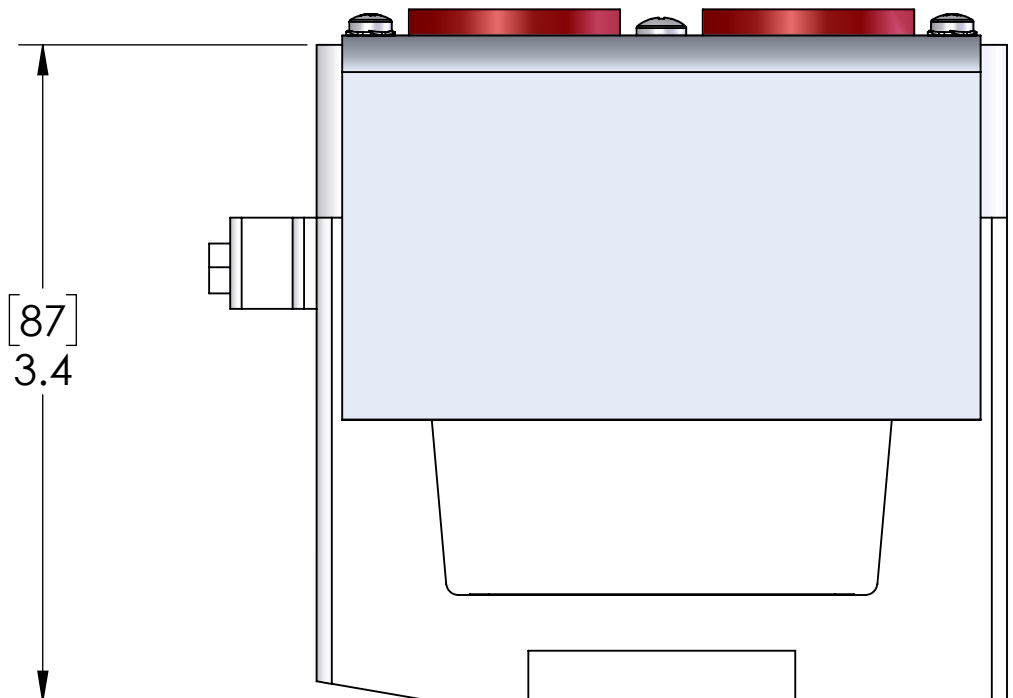

HOUSING MATERIAL	
BODY:	SELF-EXTINGUISHING THERMOPLASTIC

PIC RATINGS/SPECIFICATIONS	
VOLTS:	125V
AMPS:	15A
SCCR:	10kA
MOUNTING SCREW SIZE:	M4 (8-32)
INCOMING POWER WIRE SIZE:	0.5 ~ 4.0 sq mm / 20-12AWG
WIRE STRIP LENGTH:	10 ~ 11 mm

PROPRIETARY AND CONFIDENTIAL
THE INFORMATION CONTAINED IN THIS DRAWING IS THE SOLE PROPERTY OF MENCOM CORPORATION. ANY REPRODUCTION IN PART OR AS A WHOLE WITHOUT THE WRITTEN PERMISSION OF MENCOM CORPORATION IS PROHIBITED.

UNLESS OTHERWISE SPECIFIED:	
DIMENSIONS ARE IN INCHES AND [MM]	
MATERIAL	
FINISH	
DO NOT SCALE DRAWING	

DRAWN BY	DCG
DRAWN DATE	06/13/2019
CHECKED BY	
CHECK DATE	
COMMENTS:	

MENCOM CORPORATION		
TITLE: DINRAIL; DUPLX		
SIZE B	DWG. NO. DP-TS	REV A
SCALE: 1:1	WEIGHT:	SHEET 1 OF 1