

8 7 6 5 4 3 2 1

D

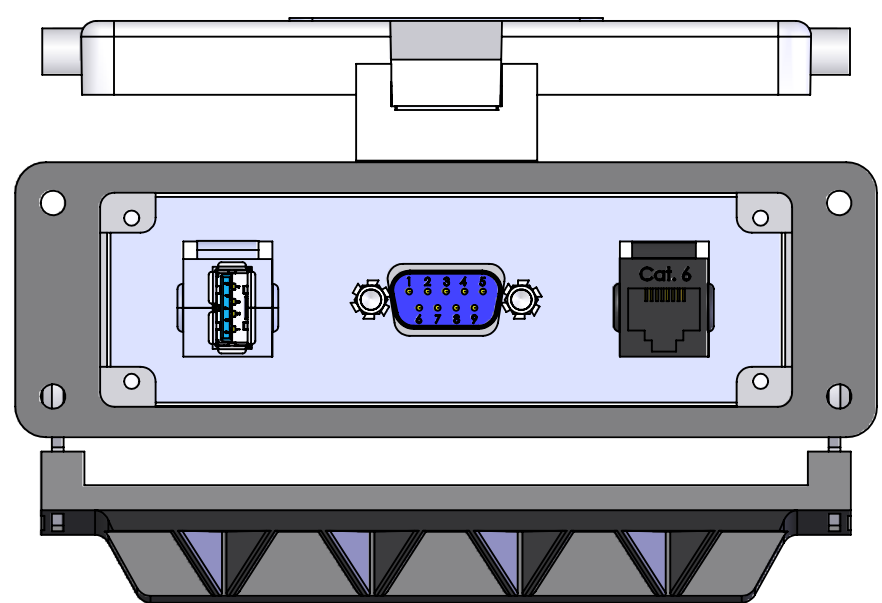
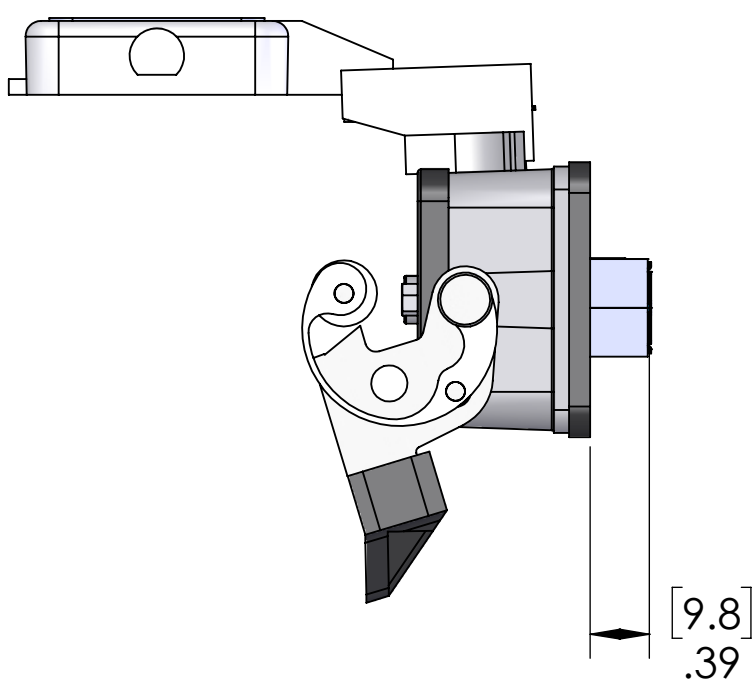
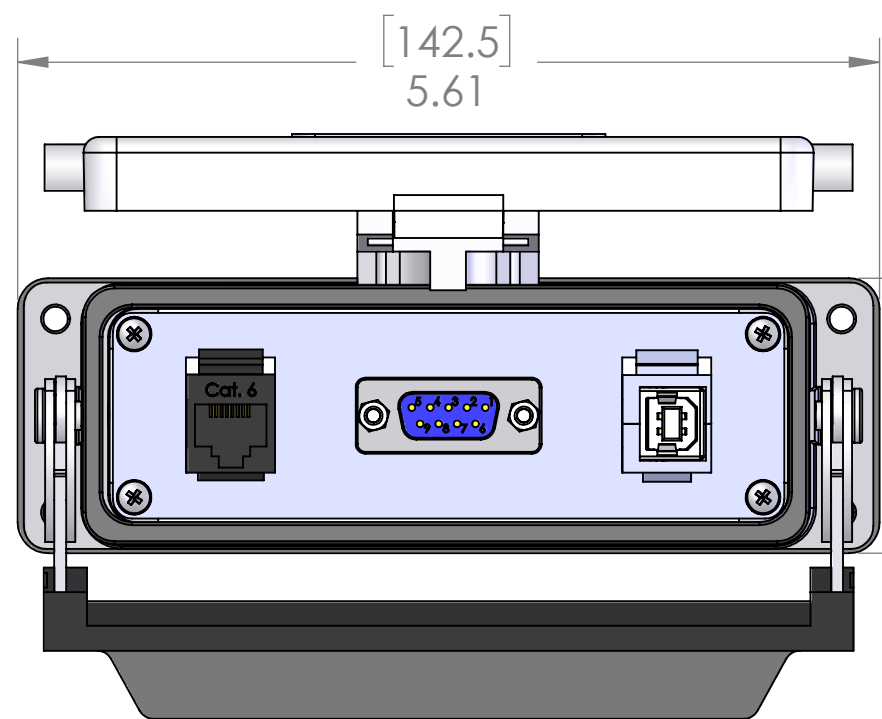

D

C

C

B

B

PANEL CUTOUT

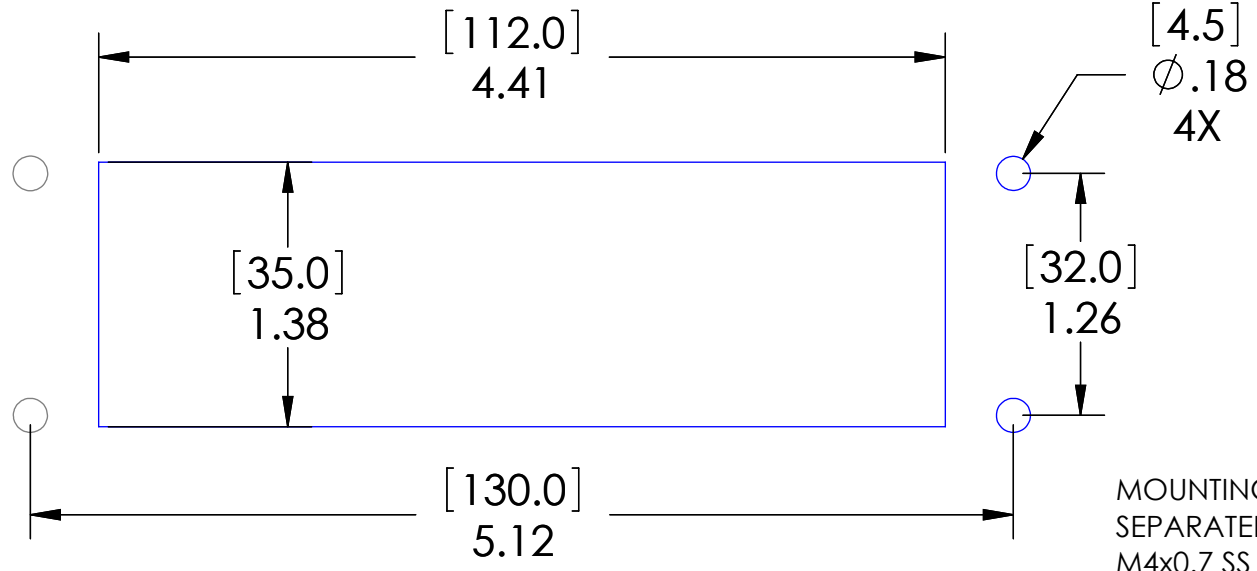

These devices shall be mounted on enclosures having adequate strength and thickness and with adequate spacing provided. Seal rating is based on mounting to a surface that is clean, flat and smooth.

HOUSING MATERIALS		PIC RATINGS/SPECIFICATIONS	
BODY:	EPOXY COATED DIE CAST ALUMINUM	NEMA/UL EN 60529:	4, 4X, 12 IP65
GASKET:	THERMOPLASTIC ELASTOMER	MOUNTING SCREW SIZE:	M4 (8-32) (304 or 316SS for 4X)
HANDLE:	POLYAMIDE	MOUNTING SCREW TORQUE:	1.2~1.8N-m (0.9~1.3 Lb-Ft)
LEVERS:	STAINLESS STEEL		

MOUNTING KIT ORDERED SEPARATELY CONTAINS M4x0.7 SS SCREW, NYLON WASHER, SPLIT LOCKWASHER AND M4 NUT
P/N: D-PIC-MT



PROPRIETARY AND CONFIDENTIAL
 THE INFORMATION CONTAINED IN THIS DRAWING IS THE SOLE PROPERTY OF MENCOM CORPORATION. ANY REPRODUCTION IN PART OR AS A WHOLE WITHOUT THE WRITTEN PERMISSION OF MENCOM CORPORATION IS PROHIBITED.

UNLESS OTHERWISE SPECIFIED:	DRAWN BY	DG
DIMENSIONS ARE IN INCHES AND [MM]	DRAWN DATE	04/11/2019
	CHECKED BY	DCG
	CHECK DATE	04/11/2019
	COMMENTS:	
MATERIAL		
FINISH		
DO NOT SCALE DRAWING		

MENCOM CORPORATION		
TITLE: DB9; RJ45; USB-BA; 24		
SIZE B	DWG. NO. DB09-RJ45-USB-BFAF-24	REV C
SCALE: 1:1	WEIGHT:	SHEET 1 OF 1

STANDARD CONFIGURATIONS UNLESS OTHERWISE NOTED		
CONN. TYPE	EXTERIOR	INTERIOR
RJ45	CAT 6 JACK	CAT 6 JACK
ALL D-SUBS	FEMALE	MALE

8 7 6 5 4 3 2 1

A

A