

(2x) USB TYPE A FEMALE (EXTERIOR)
TO TYPE A FEMALE (INTERIOR)

HDMI KEYSTONE CONNECTOR
CONFIGURED FEMALE EXTERIOR /
FEMALE INTERIOR

PANEL CUTOUT

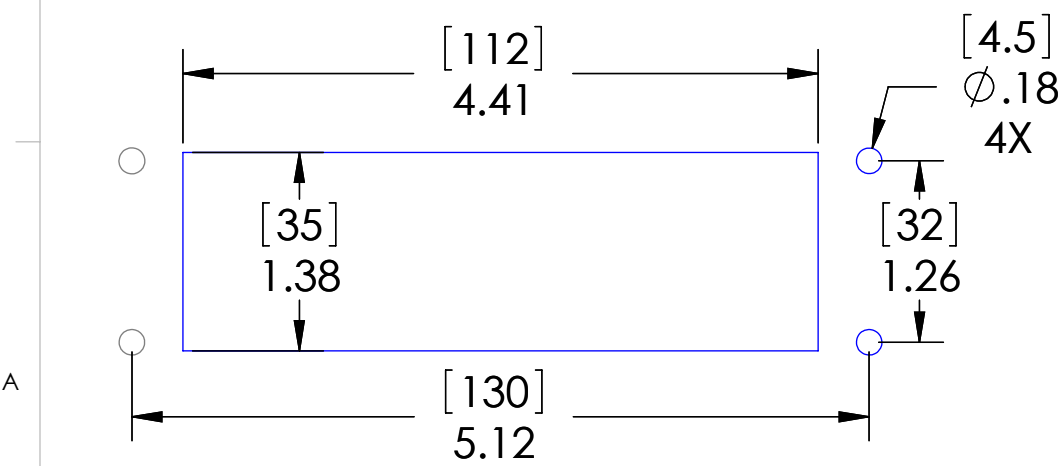

STANDARD CONFIGURATIONS UNLESS OTHERWISE NOTED		
CONN. TYPE	EXTERIOR	INTERIOR
RJ45	CAT 6 JACK	CAT 6 JACK

MOUNTING KIT ORDERED
SEPARATELY CONTAINS
M4x0.7 SS SCREW, NYLON WASHER,
SPLIT LOCKWASHER AND M4 NUT
P/N: D-PIC-MT

PROPRIETARY AND CONFIDENTIAL
THE INFORMATION CONTAINED IN THIS
DRAWING IS THE SOLE PROPERTY OF
MENCOM CORPORATION. ANY
REPRODUCTION IN PART OR AS A WHOLE
WITHOUT THE WRITTEN PERMISSION OF
MENCOM CORPORATION IS
PROHIBITED.

HOUSING MATERIALS	
BODY:	EPOXY COATED DIE CAST ALUMINUM
GASKET:	THERMOPLASTIC ELASTOMER
HANDLE:	POLYAMIDE
LEVERS:	STAINLESS STEEL



OPERATING TEMPERATURE: (-10°C / +60° C (+14° F / +140° F))	
UNLESS OTHERWISE SPECIFIED:	
DIMENSIONS ARE IN INCHES AND [MM]	
MATERIAL	
FINISH	
DO NOT SCALE DRAWING	

These devices shall be mounted on enclosures having adequate strength and thickness and with adequate spacing provided. Seal rating is based on mounting to a surface that is clean, flat and smooth.

PIC RATINGS/SPECIFICATIONS	
NEMA/UL EN 60529:	4, 4X, 12 IP65
MOUNTING SCREW SIZE:	M4 (8-32) (304 or 316SS for 4X)
MOUNTING SCREW TORQUE:	1.2~1.8N-m (0.9~1.3 Lb-Ft)
INCOMING POWER WIRE SIZE:	0.5 ~ 4.0 sq mm / 20-12AWG
WIRE STRIP LENGTH:	10 ~ 11 mm

MENCOM CORPORATION

TITLE:
HDMI; RJ45; 2USB-AA; 24

SIZE	DWG. NO.	REV
B	D-HDMI-RJ45-2USB-AFAF-24	A
SCALE: 3:4	WEIGHT:	SHEET 1 OF 1