

REVISIONS			
REV.	DESCRIPTION	DATE	APPROVED
A	REDRAWN IN SW	6/28/2007	

PG16

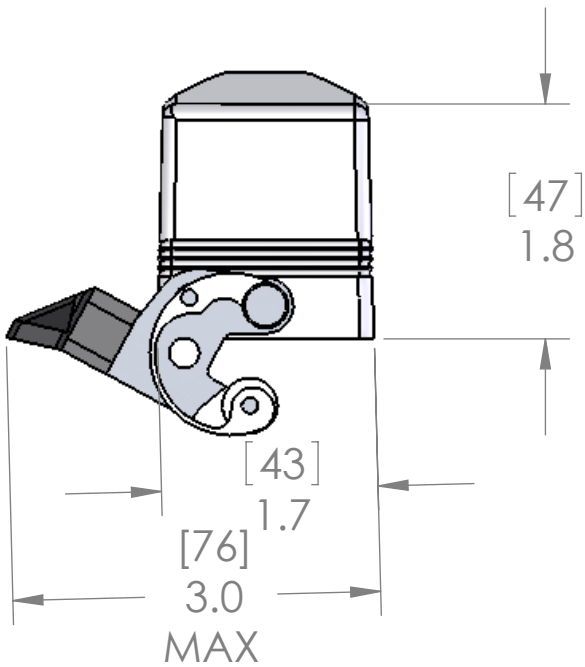
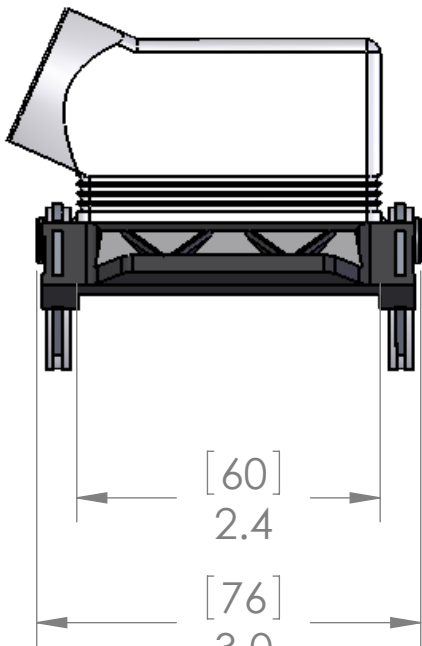
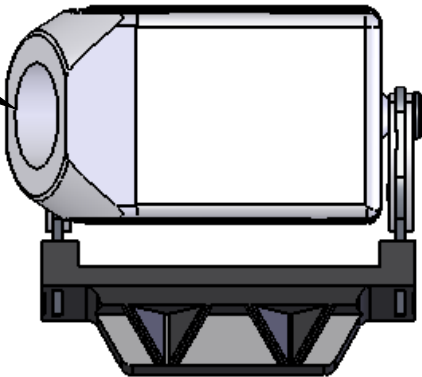

SEAL RATING OF IP 65 ONLY ACHIEVED WHEN FULLY
LATCHED TO MATING BASE AND WITH AN
APPROPRIATE SEALING GLAND INSTALLED

PROPRIETARY AND CONFIDENTIAL
THE INFORMATION CONTAINED IN THIS
DRAWING IS THE SOLE PROPERTY OF
MENCOM CORPORATION. ANY
REPRODUCTION IN PART OR AS A WHOLE
WITHOUT THE WRITTEN PERMISSION OF
MENCOM CORPORATION IS
PROHIBITED.

UNLESS OTHERWISE SPECIFIED:		NAME
DIMENSIONS ARE IN INCHES AND [MM]	DRAWN	DWM
	CHECKED	
	ENG APPR.	
	MFG APPR.	
	Q.A.	
MATERIAL	COMMENTS:	
FINISH		
DO NOT SCALE DRAWING		

HOUSING MATERIALS	
BODY:	EPOXY COATED DIE CAST ALUMINUM
LATCHES:	STAINLESS STEEL

MENCOM CORPORATION
TITLE:
**6 POLE HOOD W/LEVER
NO GASKET PG16**

SIZE	DWG. NO.	REV
B	CHO-06LX16	A
SCALE: 2:3	WEIGHT:	SHEET 1 OF 1