



7/8" JIN Junction Blocks

6 Port, 3 Pin JIN Junction blocks



Series Wiring | MIN Receptacle & Cable | IP67 Protection Rating

Trunk Style	Trunk Connection	Part Number	Circuit
	MIN Size I 3 Pole Male Receptacle	JIN-630-003-M000	
	Yellow PVC ST00W 3 x 16 AWG 600V 9.9mm OD	JIN-630-003-C**	

JIN Junction Blocks

P

Cables for JIN-630-003-M000				Female Receptacle	
Single Ended Home Run Cable		Double Ended Home Run Cable			
MIN-3FP-*	Page A-21	MIN-3MFP-*	Page A-30	MIN-3FR-1	Page A-46

* Length in feet. Standard Cable lengths are 3, 6, 12, 20, 30 & 50 feet. Consult factory for other lengths.

** Lengths in meters. Standard Cable lengths are 2, 5 & 10 meters. Consult factory for other lengths.

Standard housing is aluminum alloy, for stainless steel housing add a "SS" right after JIN. (e.g. JIN-630-003-M000 becomes JINSS-630-003-M000)

Specifications:

Housing: Black Epoxy Coated Die Cast Aluminum Alloy
 Connectors: Anodized Aluminum, Oil Resistant PVC Contact Carrier
 Cable Gland: Nickel Plated Brass, Polyamide and TPE Inserts
 Contacts: Copper Alloy with Gold Plating
 Temperature: -30 °C to +80 °C (-22°F to +176°F)
 Amperage: 4A per Port, 8A per Unit

Internal jumper
Pin #2 to Pin #3

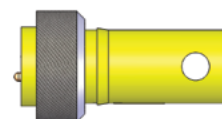

Jumper plug for use on unused inputs

Jumper Plug Part # MIN-3MP-DP1