

CR coding pins

coding and guide pins, for 72 codings



description	part No.	part No
double coding pins (excluding MIXO inserts) male pin female pin single code pin	stainless steel CRM CRF CR 72	zinc plated iron CRM D CRF D CR 72 D
double coding pins (for MIXO inserts only) male pin female pin single code pin	stainless steel CRM CX CRF CX CR 72 CX	zinc plated iron CRM CX D CRF CX D CR 72 CX D

Coding pins

- CRM/CRM D, CRF/CRF D and CR 72/CR 72 D
- CRM CX/CRM CX D, CRF CX/CRF CX D and CR 72 CX/CR 72 CX D

Each series of connector inserts is made in such a way as to make incorrect coupling between inserts of different series impossible.
When a number of identical connectors with different functions are mounted closely together these must be selected in such a way as to prevent the coupling of a mobile part on a non-corresponding fixed part and consequent damage and breakdown.

Code pins are supplied to apply in place of the normal insert fastening screws.
In this way the coupling of identical connectors is assured.
The combination of code pins makes it possible to obtain a high number of selective couplings.

CRM / CRM D

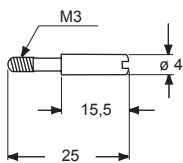

CRF / CRF D

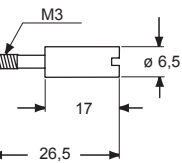

CR 72 / CR 72 D

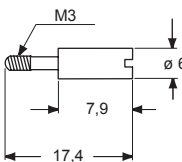

CRM CX / CRM CX D

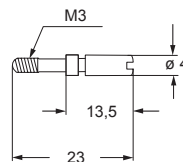

CRF CX / CRF CX D

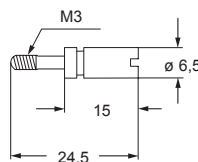

CR 72 CX
CR 72 CX D

